



个人微信



www.dalier.cn



1688.com

▶ WWW.DALIER.CN



DALIER[®] 产品选型手册
PRODUCT SELECTION MANUAL



WWW.DALIER.CN

WWW.DALIER.CN

COMPANY

INTRODUCTION

企业简介

乐清市达利尔电器是一家专业从事设计和开发线路终端和连接器、尼龙扎线带、电缆附件和接线端子与出色的经验生产此类产品。

Yueqing dalier electrical appliance factory is specialized in designing and developing wiring terminals and connectors, nylon cable ties, cable accessory and terminal blocks with excellent experience to manufacture such products.



我们的优势

产品品种众多

So Many Products

高纯度的材料

High Purity Material

一流的工程师

First-class Engineer

一流的设备

First-class Equipment

公司生产技术标准严格引用先进的工业和研究由美国国家电气控制和分配设备质量监督检测中心,是在1998年获得ISO9001国际质量体系认证。它拥有一流的设备和开发工程师,产品使用高纯度的材料。接触系列齐全,品种众多,欢迎,许多客户以其优良的品质和优惠的价格!

本公司保留原则“优良的品质,超过信用、客户第一”全心全意为大众服务的用户。我们愿意创建世界塞满品牌和产品与客户!

The company is producing strictly reference to the technical standard advanced industrial and examined by the national electrical control and distribution equipment quality supervision testing center, is have obtained iso9001 international quality system certificate in 1998. It possessing first-class equipment and developing engineers, products are made that use the high purity material. The contact series are complete, numerous in varieties, that are welcome to many clients for its excellent quality and favourable price!

Our company with holding the principle " excellent quality, exceeding credit, clients first" to serve the mass of users heart and soul. We are willing to create the world -leading brand and products with clients!

www.dalier.cn



1998年获得ISO9001

达利尔创自己的品牌
Dalier create ourself brand



EQUIPMENT AND PRODUCTION

设备与生产

达利尔创自己的品牌

Dalier create ourself brand



DALIER

为保证产品质量的稳定性和可靠性，我们坚持国际质量标准体系运行，并对产品进行检测监控--我们的高标准是因为我们对品牌完美的追求，我们的诸多认证不仅仅是我们的荣誉，更是我们前进的动力！

To ensure the stability and reliability of product quality, we always implement the international quality standard system, and stress on the inspection, test and monitoring of the products. Our high standard is from the pu-rsuit of perfect brand, and our many certificates acqui-red represent not only our honors, but also our advan-cing power.

www.dalier.cn

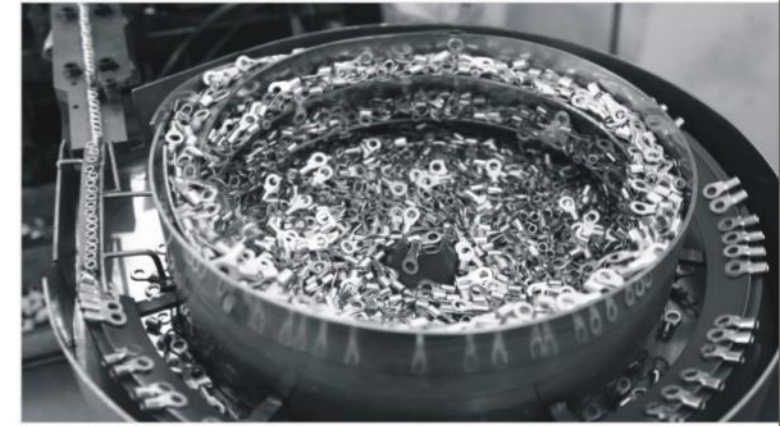

DALIER®



荣誉 更是 动力

HONOR IS MORE MOTIVATION



端头型号说明 CATEGORY INTRODUCTION

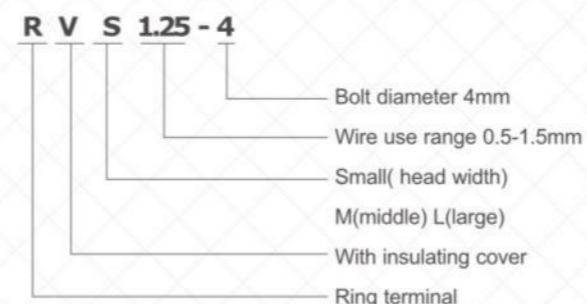

说明1 Introduction 1

110:0.110"	(2.8mm)
187:0.187"	(4.75mm)
205:0.205"	(5.2mm)
250:0.250"	(6.35mm)
312:0.312"	(8.0mm)
375:0.375"	(9.4mm)
156:0.156"	(4mm)
195:0.195"	(5mm)

说明2 Introduction 2

R	圆形端头 Ring terminal
S	叉形端头 Fork terminal
H	钩形端头 Hook terminal
PT	针形端头 Pin terminal
FD	母接头 Female connector
MD	公接头 Male connector
FR	子弹形母接头 Bullet female connector
MP	子弹形公接头 Bullet male connector
DB	片形端头 Chip terminal
LS	锁扣叉形端头 Snapclose furcate terminal
FS	凸形叉形端头 Male chip terminal
LB	凹片形端头 Female chip terminal
BV	长形中间接头 Long full terminal
FLD	旗形母接头 Flag female terminal
DFD	母全绝缘端头 Female full-insulating terminal
PVT	短形中间接头 Short middle terminal
PBD	肩背形公、母接头 Shalle shaped

说明3 Introduction 3

Wire	Wire section(mm ²)	America wire(A.W.G)
1.25	0.5-1.5	22-16
2	1.5-2.5	16-14
3.5	2.5-4	14-12
5.5	4-6	12-10
8	6-10	8
14	10-16	6
22	16-25	4
38	25-35	2
60	50-70	1/0
70	70-95	2/0
80	95-120	3/0
100	120-150	4/0
150	150-185	250/300MCM
180	185-240	300/350MCM
200	240-300	400/500MOM
325	300-400	500/600MOM

说明4 Introduction 4

Bolt pass diameter(mm)	Amedca wire(mm)
3.2	#4
3.7	#6
4.3	#8
5.3	#10
6.4	1/4
8.4	5/16
10.5	3/8
11.0	7/8

Bolt pass diameter(mm)	Amedca wire(mm)
13.0	1/2
15.0	9/16
17.0	5/8
18.0	11/16
21.0	3/4
23.0	7/8
25.0	15/16
28.0	1

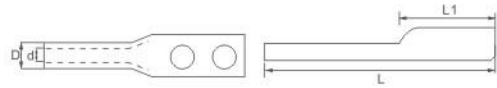

TWO HOLE LONG BARREL COPPER LUGS

双孔长臂铜接头

■ TWO-Hole Lug long Barrel

U.L.listed per 486A upto 35KV.

Ideal for industrial,Oil rig,mining,welding & transportation termination application.Heavy duty design which permits additional crimp for added mechanical strength.

型号 ITEM NO.	尺寸 Dimension(mm)				颜色 Color	A.W.G
	d	D	L	L1		
2L16M6	4.8	7.5	66	35	Blue	6
2L25M6	6	8.7	68	34	Gray	4
2L35M8	7.5	10.5	78.5	36	Brown	2
2L50M8	10	13	85	45	Pink	1/0
2L70M12	11	14.5	122.5	47	Black	2/0
2L95M12	13.5	17.5	129	53	Purple	4/0
2L120M12	15	19	131	55	Yellow	250KCMIL
2L150M12	18	22.5	144	67.5	Red	350KCMIL
2L185M12	19	24	153	76	Blue	400KCMIL
2L240M12	21	27	155	76	Brown	500KCMIL
2L300M12	22.5	29	172	90	Green	600KCMIL
2L400M12	26	33	168	92	Black	750KCMIL
2L500M12	30	38	160	98	White	1000KCMIL

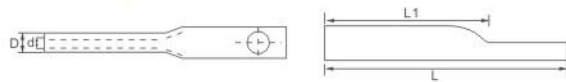

ONE HOLE LONG BARREL COPPER LUGS

单孔长臂铜接头

■ ONE-Hole Lug long Barrel

U.L.listed per 486A upto 35KV.

Ideal for industrial,Oil rig,mining,welding & transportation termination application.Heavy duty design which permits additional crimp for added mechanical strength.

型号 ITEM NO.	尺寸 Dimension(mm)				颜色 Color	A.W.G
	d	D	L	L1		
L10M6	5.0	7	38.7	22	RED	8
L16M6	4.8	7.5	53.5	36.5	Blue	6
L25M6	6	8.7	52.5	35	Gray	4
L35M8	7.5	10.5	52.5	33	Brown	2
L50M8	10	13	62	42.5	Pink	1/0
L70M10	11	14.5	69.5	47.5	Black	2/0
L95M12	13.5	17.5	85	53	Purple	4/0
L120M12	15	19	85	55	Yellow	250KCMIL
L150M12	18.5	22	94.5	67	Red	350KCMIL
L185M16	19	24	154	75.5	Blue	400KCMIL
L240M16	21	27	116	78	Brown	500KCMIL
L300M16	22.5	29	125	91.8	Green	600KCMIL
L400M16	26	33	135	95	Black	750KCMIL
L500M16	30	38	143	102	White	1000KCMIL



ONE HOLE OFFSET FLOATING TONGUE LUGS

单孔浮动偏舌形接头

High copper alloy terminal with offset tongue for joining a wide range of cable to equipment pads or bar. Easy to install with screwdriver or wrench. Connector is re-usable. Plain copper finish.

特性 Features	优势 Benefits
Convenient range-taking design.	Reduces catalog number. Oneconnector accommo- -dates several conductor sizes.
High conductivity copper alloy.	Long lasting reliable contact.
Compact design.	Easy to use, Reduces labor time.
Slot Robertson screw,hex head/hex socket bolt.	No special installation tools requ ired Eliminates over-torquing/potential conductor damage.

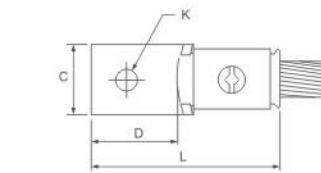

Fig.1

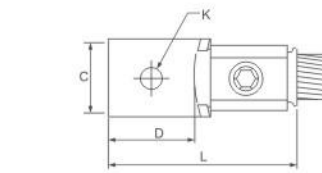

Fig.2

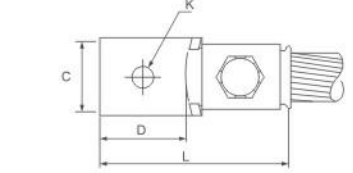

Fig.3

All size are inch

型号 Catalog Number	图号 FIG	线径范围 Wire Range	尺寸 Dimension(mm)					螺栓孔尺寸 Stud hole size	L	螺杆型式 Screw type	螺杆尺寸 Screw size	推荐拧紧力矩 Recommendes tightening torque
			B	C	D	H	K					
KLU25	1	14-10	0.28	0.31	0.47	0.66	0.14	8	0.91	Slot Robertson	8/32	20
KLU35	1	14-6	0.43	0.38	0.57	0.91	0.20	10	1.71	Slot Robertson	1/4	45
KLU70	1	8-2	0.50	0.50	0.61	1.05	0.27	1/4	1.32	Slot Robertson	5/16	50
KLU125	1	2-1/0	0.61	0.62	0.86	1.50	0.26	1/4	1.78	Slot Robertson	3/8	50
KLU175	2	4-3/0	0.75	0.75	1.20	1.40	0.41	3/8	2.20	Hex Socket	3/8	124
KLU225	2	2-4/0	1.00	1.00	1.24	1.64	0.34	5/16	2.54	Hex Socket	7/16	204
KLU300	3	1/0-350	1.21	1.10	1.60	2.63	0.41	3/8	3.25	Hex Head	5/8	325
KLU400	3	1/0-500	1.49	1.50	2.12	2.74	0.41	3/8	4.26	Hex Head	5/8	375
KLU650	3	600-1000	1.88	2.00	1.90	3.73	0.53	1/2	4.61	Hex Head	3/4	500

ALUMINUM DUAL RATED LUGS

铝合金双额定接线端子

For use with two copper or aluminum conductors

- Manufactured from high strength aluminum alloy extrusion
- Electro-tin plated to ensure minimum contact resistance and corrosion protection Connectors are rated for 600 V, 90 C applications
- The use of oxide inhibitor is recommended for all aluminum terminations

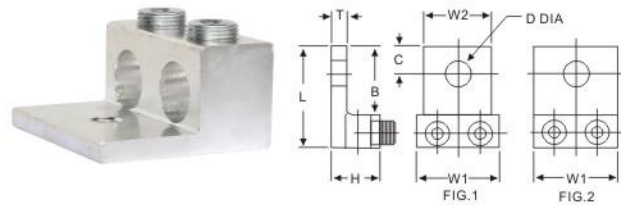

TWO HOLE TONGUE TYPE L2A

CATALOG NUMBER	FIG. NO.	CONDUCTOR RANGE	APPROXIMATE DIMENSIONS(IN.)								MTG. BOLT SIZE	HEX SIZE
			L	W1	W2	H	T	B	C	D (DIA.)		
L2A-0	2	14 Str.-1/0 Str.	1.47	1.13	-	0.78	0.18	0.84		0.44	1/4	SLOT
L2A-2/0	2	14 Str.-2/0 Str.	1.47	1.25	-	0.78	0.18	0.84		0.27	1/4	SLOT
L2A-250	2	6 Str.-250 kcmil	2.56	1.64	-	1.18	0.25	1.56		0.41	3/8	5/16
L2A-350	1	6 Str.-350 kcmil	2.88	1.94	1.75	1.25	0.25	1.75		0.53	1/2	3/8
L2A-500	1	4 Str.-500 kcmil	3.13	2.38	1.98	1.56	0.44	1.75		0.53	1/2	3/8
L2A-600	1	2 Str.-600 kcmil	3.13	2.38	1.98	1.56	0.44	1.75		0.53	1/2	1/2
L2A-800	2	350-800 kcmil	3.50	3.50	-	1.94	0.50	1.88		0.66	5/8	1/2
L2A-1000	2	500-1000 kcmil	3.50	3.50	-	1.94	0.50	1.88		0.66	5/8	1/2



ONE HOLE TONGUE TYPE L2A

CATALOG NUMBER	CONDUCTOR RANGE	APPROXIMATE DIMENSIONS(IN.)								MTG. BOLT SIZE	HEX SIZE
		L	W	H	T	B	C	D (DIA.)			
LA-6	14 Str.-4 Str.	1.06	0.50	0.50	0.09	0.69	0.25	0.27		1/4	Slot
LA-2	14 Str.-2 Str.	1.16	0.50	0.55	0.11	0.69	0.31	0.27		1/4	Slot
LA2-516*	14 Str.-2 Str.	1.16	0.50	0.56	0.10	0.69	0.31	0.33		5/16	Slot
LA-0	14 Str.-1/0 Str.	1.47	0.63	0.78	0.19	0.84	0.42	0.27		1/4	Slot
LA-2/0	14 Str.-2/0 Str.	1.47	0.63	0.80	0.19	0.84	0.44	0.27		1/4	3/16
LA-250	6 Str.-250 kcmil	2.00	1.00	1.13	0.25	1.00	0.45	0.33		5/16	3/8
LA-350	6 Str.-350 kcmil	2.25	1.13	1.25	0.25	1.13	0.50	0.41		3/8	3/8
LA-500	4 Str.-500 kcmil	2.81	1.25	1.56	0.31	1.56	0.88	0.41		3/8	3/8
LA-600	2 Str.-600 kcmil	3.13	1.50	1.56	0.44	1.81	0.88	0.53		3/8	3/8
LA-800	300-800 kcmil	3.50	1.75	1.94	0.50	1.88	0.81	0.66		5/8	1/2
LA-1000+	500-1000 kcmil	3.50	1.75	1.94	0.50	1.88	0.81	0.66		5/8	1/2

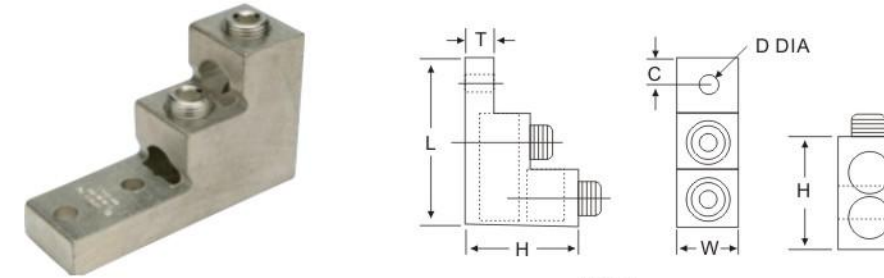

FIG.1

PANELBOARD LUGS TYPE PB

CATALOG NUMBER	FIG. NO.	NUMBER OF CONDUCTORS	CONDUCTOR RANGE	APPROXIMATE DIMENSIONS(IN.)								MTG. BOLT SIZE	HEX SIZE
				L	W	H	T	C	D (DIA.)	E			
PB2-300	1	2	6 Str.-300 kcmil	3.00	1.00	2.00	0.31	0.47	0.33	-	5/16	5/16	
PB2-600	2	2	2 Str.-600 kcmil	4.91	1.50	3.00	0.75	0.38	0.41	1.38	3/8	3/8	
PB2-750	2	2	1/0 Str.-750 kcmil	4.91	1.56	3.00	0.75	0.38	0.41	1.38	3/8	3/8	
PB3-600	3	3	2 Str.-600 kcmil	4.91	2.50	3.00	0.75	0.38	0.41	1.38	3/8	3/8	
PB3-750	3	3	1/0 Str.-750 kcmil	4.91	2.84	3.00	0.75	0.38	0.41	1.38	3/8	3/8	
PB4-600	4	4	2 Str.-600 kcmil	4.91	2.50	3.00	0.75	0.38	0.41	1.38	3/8	3/8	
PB4-750	4	4	1/0 Str.-750 kcmil	4.91	2.84	3.00	0.75	0.38	0.41	1.38	3/8	3/8	



Bronze Two Bolt Connector

双螺栓连接器

- Made from high strength bronze for heavy duty connections and inhibit corrosion
- Cap swivels for easy installation of conductors
- High strength silicon-bronze hardware provides premium mechanical performance when assembled to conductor
- Wide wire range-taking capability minimizes inventory requirements
- UL Listed for use up to 600V and 90°C temperature rated

TYPE	CONDUCTOR RANGE		APPROXIMATE DIMENSIONS (INCH)				BOLT SIZE
			A (BOLT LENGTH)	B	D	E	
	MAIN	TAP					
VT-0	2 Str. - 1/0 Str.	10 Str. - 1/0 Str.	1.5	0.41	1.44	0.94	5/16.
VT-1	2 Str. - 2/0 Str.	10 Str. - 2/0 Str.	1.5	0.5	1.56	1.13	5/16.
VT-2	1/0 Str. - 4/0 Str.	10 Str. - 4/0 Str.	1.75	0.59	1.84	1.34	3/8.
VT-3	250 - 350 kcmil	10 Str. - 350 kcmil	2	0.75	2.31	1.63	1/2.
VT-4	250 - 500 kcmil	10 Str. - 500 kcmil	2.25	0.88	2.44	1.69	1/2.
VT-5	400 - 800 kcmil	3/0 Str. - 800 kcmil	2.5	1.06	2.69	1.88	1/2.
VT-6	500 - 1000 kcmil	3/0 Str. - 1000 kcmil	2.75	1.25	3.06	2.25	5/8.

GTY COPPER CONNECTING TUBE

GTY 铜接线管

Applicable for the connection of the circular wire, hemicycle wire with power supply cable in distribution equipment. That made of higher 99.9% pure T2 copper tube and coated tin

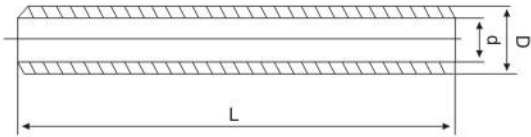

Type	Dimensions(mm)		
	D	d	L
GTY-1.5	3.7	1.8	20
GTY-2.5	4	2.5	20
GTY-4	4.8	3.1	20
GTY-5.5	5.5	3.8	25
GTY-10	6.8	4.8	30
GTY-16	7.5	5.5	35
GTY-25	9	7	40
GTY-35	10.5	8.2	45
GTY-50	12.5	9.8	50
GTY-70	14.5	11.5	55
GTY-95	17.5	13.5	60
GTY-120	19.5	15	65
GTY-150	21	16.5	70
GTY-185	23.5	18.5	75
GTY-240	26.5	21	80
GTY-300	30	24	85
GTY-400	34	27	90
GTY-500	38	30	100
GTY-630	45	35	110
GTY-800	50	39	150
GTY-1000	56	44	170

ONE HOLE STRAIGHT FLOATING TONGUE LUGS

单孔浮动直舌型接头

Manufactured from electrolytic copper for maximum conductivity and strength Compact design joins a wide range of copper conductors to equipment or terminal blocks for power and grounding applications

Plated steel set screws resist corrosion
For tin plating, suffix catalog number with -TN

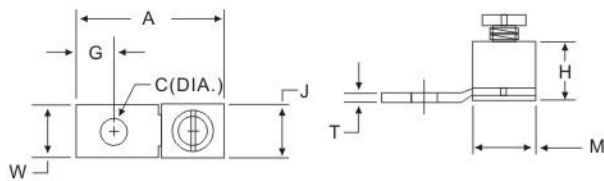

Fig.1

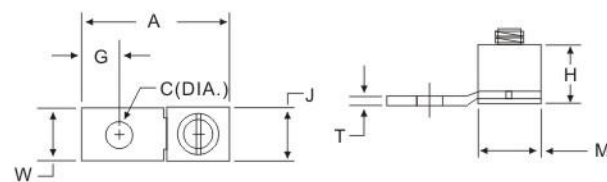

Fig.2

CATALOG NUMBER	FIGURE NO.	COPPER CONDUCTOR RANGE	APPROXIMATE DIMENSIONS(IN.)							AMPERE RATING NEC	SET SCREW TYPE	
			A	W	G	C(DIA.)	T	M	H			J
SLS-35	1	6 Str.-14 Str.	1.00	0.37	0.24	0.20	0.06	0.37	0.47	0.34	35-50	Pan Head Slotted
SAS-70	2	4 Str.-14 Str.	1.26	0.50	0.38	0.27	0.08	0.49	0.53	0.44	70	Headless Sotted

COPPER ALLOY SPLIT BOLT CONNECTOR

铜合金拆分螺栓连接器

Types S and SEL

- Manufactured from high strength copper alloy - highly resistant to corrosion and season cracking
- For use with a wide range of copper solid, compact, compressed, concentric, copperweld conductors, and rebar
- Approved for electrical power, grounding/bonding, and direct burial applications

High Quality Design:

- True hex design allows easy installation with standard tooling
- Under torque, this design provides high contact pressure between conductors or conductor to rebar
- Pressure bar design features give assurance of high pull-out and secure connection on all combinations of conductors* Wide wire range
- Rated for copper conductors, 600 V, 90C

Installation:

- Use with torque wrench, standard socket, box or open-end wrenches
- Reusable with proper installation practice

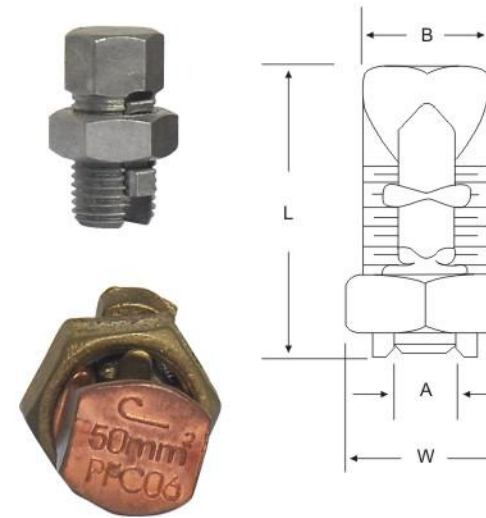

Type S-Two Conductors

CATALOG NUMBER	RANGE OF EQUAL RUN & TAP	MIN.TAP W/ONE MAX.MAIN	MAX.CONDUCTOR COPPERWELD		UL ONLY REBAR W/ 6 OR 8 AWG	APPROXIMATE DIMENSIONS(IN.)				TORQUE (IN-LBS)
			STR.	TYPE A		L	W	B	A	
S-10*	16 Str.-10 Str.	16 Str.	-	-	-	0.72	0.50	0.34	0.13	80
S-8*	16 Str.-8 Str.	16 Str.	-	-	-	0.84	0.50	0.38	0.15	80
S-6*	10 Sol.-6 Str.	16 Sol.	-	-	-	1.05	0.63	0.50	0.17	165
S-4*	8 Sol.-4 Sol.	16 Sol.	3 No.12	8A	-	1.05	0.69	0.56	0.22	165
S-3*	6 Sol.-2 Sol.	12 Sol.	3 No.9	5A	-	1.32	0.81	0.69	0.33	275
S-2*	6 Sol.-2 Str.	14 Str.	3 No.7	3A	-	1.32	0.81	0.69	0.33	275
S-1/0*	4 Sol.-1/0 Str.	14 Sol.	3 No.6	2A	-	1.64	0.88	0.75	0.38	385
S-2/0	2 Sol.-2/0 Str.	14 Str.	3 No.5	-	#3(3/8)	1.82	1.00	0.81	0.42	385
S-3/0	2 Sol.-3/0 Str.	12 Sol.	7 No.7	-	-	2.00	1.13	0.88	0.47	500
S-4/0-250	1/0 Sol.-250 kcmil	10 Sol.	7 No.5	-	#4(1/2)	2.08	1.31	1.00	0.58	650
S-350+	4/0 Str.-350 kcmil	8 Sol.	19 No.7	-	#5(5/8)	2.63	1.63	1.50	0.75	650
S-500+	250-500 kcmil	8 Sol.	19 No.6	-	#6(3/4)	3.00	1.81	1.63	0.83	825
S-750++	350-750 kcmil	8 Sol.	19 No.5	-	-	3.75	2.13	1.94	1.03	100
S-1000++	500-1000 kcmil	8 Sol.	-	-	-	4.00	2.50	2.25	1.22	1100

Type SEL-Two Three Conductors

CATALOG NUMBER	RANGE OF EQUAL RUN & TAP	MIN.TAP W/ONE MAX.MAIN	MAX.CONDUCTOR COPPERWELD		APPROXIMATE DIMENSIONS(IN.)				TORQUE (IN-LBS)
			STR.	TYPE A	L	W	B	A	
SEL-8*	16 Str.-8 Str.	16 Str.	-	-	0.84	0.50	0.38	0.14	80
SEL-6*	10 Sol.-6 Sol.	16 Sol.	-	-	1.09	0.63	0.50	0.17	165
SEL-4*	8 Sol.-4 Sol.	16 Sol.	3 No.12	8A	1.27	0.69	0.56	0.22	165
SEL-2*	6 Sol.-2 Str.	14 Str.	3 No.7	8A	1.55	0.81	0.69	0.33	275

Special develop and supply AWG terminal and conector,types with detail data.
 特别开发和供应美国标准系列端头和接头，列表中有型号和具体参数。

List Of Parameters

端头参数一览表



ITEM NO.	Wire Range (AWG)	Stud Size	L(Inch)	Thickness	Barrel Length	Barrel I.D.
917535	26-22	#6	0.591	0.02	0.25	0.045
917504	26-22	#8	0.681	0.02	0.25	0.045
917505	26-22	#10	0.724	0.02	0.25	0.045
917506	26-22	1/4	0.854	0.02	0.25	0.045
911035	22-18	#6	0.685	0.03	0.25	0.07
911004	22-18	#8	0.728	0.03	0.25	0.07
911005	22-18	#10	0.732	0.03	0.25	0.07
911005L	22-18	#10	0.701	0.03	0.25	0.07
911006	22-18	1/4	0.917	0.03	0.25	0.07
912035	16-14	#6	0.795	0.03	0.25	0.09
912004	16-14	#8	0.795	0.03	0.25	0.09
912005	16-14	#10	0.709	0.03	0.25	0.09
912005L	16-14	#10	0.787	0.03	0.25	0.09
912006	16-14	1/4	0.917	0.03	0.25	0.09

ITEM NO.	Wire Range (AWG)	Stud Size	L(Inch)	Thickness	Barrel Length	Barrel I.D.
912006L	16-14	1/4	0.917	0.03	0.25	0.09
912008	16-14	5/16	0.921	0.03	0.25	0.09
912008L	16-14	5/16	0.923	0.03	0.25	0.07
912010	16-14	3/8	0.949	0.03	0.25	0.09
915004	12-10	#8	0.900	0.04	0.25	0.135
915005	12-10	#10	0.709	0.04	0.25	0.135
915005L	12-10	#10	0.906	0.04	0.26	0.135
915006	12-10	1/4	0.937	0.04	0.25	0.135
915006L	12-10	1/4	0.957	0.04	0.25	0.135
915006L	12-10	1/4	0.996	0.04	0.26	0.135
915008	12-10	5/16	1.004	0.04	0.26	0.135
915010	12-10	3/8	1.047	0.04	0.26	0.135
915012	12-10	1/2	1.114	0.04	0.26	0.135

List Of Parameters

端头参数一览表

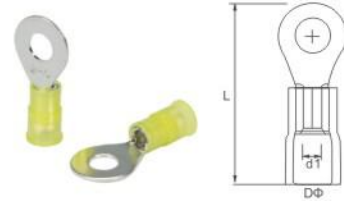

NYLON+ COPPER SLEEVE	Wire Range (AWG)	Stud Size	L(Inch)	D	Thickness	Barrel Length	
921035	931035	22-18	#6	0.925	0.03	0.25	0.07
921035L	931035L	22-18	#6	0.965	0.03	0.25	0.07
921004	931004	22-18	#8	0.969	0.03	0.25	0.07
921005	931005	22-18	#10	0.972	0.03	0.25	0.07
921005L	931005L	22-18	#10	0.945	0.03	0.25	0.07
921006	931006	22-18	1/4	1.173	0.03	0.25	0.07
922035	932035	16-14	#6	0.846	0.03	0.25	0.09
922004	932004	16-14	#8	0.846	0.03	0.25	0.09
922005	932005	16-14	#10	0.965	0.03	0.25	0.09
922005L	932005L	16-14	#10	1.031	0.03	0.25	0.09
922006	932006	16-14	1/4	1.157	0.03	0.25	0.09
922006L	932006L	16-14	1/4	1.169	0.03	0.25	0.09
922008	932008	16-14	5/16	1.076	0.03	0.25	0.09
922008L	932008L	16-14	5/16	1.169	0.03	0.25	0.09

NYLON+ COPPER SLEEVE	Wire Range (AWG)	Stud Size	L(Inch)	D	Thickness	Barrel Length	
922010	932010	16-14	3/8	1.193	0.03	0.25	0.09
922010L	932010L	16-14	3/8	1.165	0.03	0.25	0.09
925004	935004	12-10	#8	0.937	0.04	0.25	0.135
925005	935005	12-10	#10	1.024	0.04	0.25	0.135
925005M	935005M	12-10	#10	1.201	0.04	0.26	0.135
925005L	935005L	12-10	#10	1.264	0.04	0.26	0.135
925006	935006	12-10	1/4	1.252	0.04	0.25	0.135
925006M	935006M	12-10	1/4	1.291	0.04	0.26	0.135
925006L	935006L	12-10	1/4	1.272	0.04	0.26	0.135
925008	935008	12-10	5/16	1.299	0.04	0.26	0.135
925008L	935008L	12-10	5/16	1.272	0.04	0.26	0.135
925010	935010	12-10	3/8	1.343	0.04	0.26	0.135
925012	935012	12-10	1/2	1.409	0.04	0.26	0.135

AWG series

THE INDEX 端头索引

AWG (American Wire Gauge) terminal and connector suit for American market and area that use such standard, for example: USA, CANADA, MEXICO, COLOMBIA, BRAZIL, KINGDOM OF SAUDI, PHILIPPINES etc.



DALIER ELECTRIC TERMINALS & CONNECTORS



SPECIAL PIN XINYL-INSULATED TERMINAL

特殊针形预绝缘端头

Manufactured in copper with tin coating by galvanic electroplating process.

Dimensions Listed In Table Are Aproximate



TPP-10 8AWG 10mm ²	TPP-16 6AWG 16mm ²	TPP-25 4AWG 25mm ²	TPP-35 2AWG 35mm ²

SPECIAL TUBULAR VINYL-INSULATED TERMINAL

特殊管形预绝缘端头

Manufactured in copper with tin coating. Can be used with ATP-49 or similar type pliers.

Dimensions Listed In Table Are Aproximate



型号 ITEM NO.	孔径 Φ HOLE (mm)	导体尺寸 Conductor size	
		A.W.G	mm ²
TPT-10	4-5-6-8	8	10.0
TPT-16	5-6-8	6	16.0
TPT-25	5-6-8-10	4	25.0
TPT-35	6-8-10-12	2	35.0
TPT-50	6-8-10-11-12	1/0	50.0
TPT-70	6-8-10-11-12	2/0	70.0

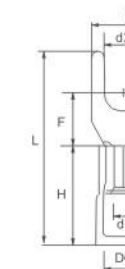

SV NSV

SPADE VINYL-INSULATED TERMINAL(TU-JTK) PVC绝缘叉形端头

型号 ITEM NO.	美制螺栓号 USA SCREW	螺栓口直径 Screw dia. d2Φ(mm)	尺寸 Dimension(mm)						颜色 Color	说明 Explanation
			B	L	F	H	DΦ	T		
SV 1.25-3	#4	3.2	5.7	21.6	6.5	10	4.3	0.7	红 Red	导线截面: 0.5-1.5mm ² (美国线规22~16) 最大电流: 19A 材质: PVC和紫铜 镀层: 铜锡或亚锡 注: 易进式 (ESV), 加铜套 (C-SV) Cable size: 0.5-1.5mm ² Max current: I _{max} =19A Material: PVC+Copper Plating: Tin
SVS 1.25-3.5	#6	3.7	5.7	21.6	6.5					
SVL 1.25-3.5	#6	3.7	6.4	21.2	6.5					
SVS 1.25-4	#8	4.3	8.0	21.2	6.5					
SVM 1.25-4	#8	4.3	7.2	21.2	6.5					
SVL 1.25-4	#8	4.3	8.1	21.2	6.5					
SVS 1.25-5	#10	5.3	8.1	21.2	6.5					
SVL 1.25-5	#10	5.3	9.5	21.2	6.5					
SVS 1.25-6	1/4	6.4	9.5	21.2	6.5					
SVL 1.25-6	1/4	6.4	12.0	27.2	11.0					
SV 2-3	#4	3.2	6.5	21.6	5.7	10.6	4.9	0.8	蓝 Blue	导线截面: 1.5-2.5mm ² (美国线规16~14) 最大电流: 27A 材质: PVC和紫铜 镀层: 铜锡或亚锡 注: 易进式 (ESV), 加铜套 (C-SV) Cable size: 1.5-2.5mm ² Max current: I _{max} =27A Material: PVC+Copper Plating: Tin
SVS 2-3.5	#6	3.7	6.5	21.2	5.7					
SVL 2-3.5	#6	3.7	6.5	21.2	6.0					
SVS 2-4	#8	4.3	6.5	21.2	6.4					
SVM 2-4	#8	4.3	6.5	21.2	7.2					
SVL 2-4	#8	4.3	6.5	21.2	8.1					
SVS 2-5	#10	5.3	6.5	21.2	8.1					
SVL 2-5	#10	5.3	6.5	21.2	9.5					
SVS 2-6	1/4	6.4	6.5	21.2	9.5					
SVL 2-6	1/4	6.4	11.0	27.8	12.0					
SV3.5-3	#4	3.2	7.0	26.8	5.7	13.0	6.2	1.0	黑 Black	Cable size: 2.5-4mm ² A.W.G: 14-12 Max current: I _{max} =37A Material: PVC+Copper Plating: Tin
SV3.5-4	#8	4.3	7.0	24.8	8.0					
SV3.5-5	#10	5.3	7.0	24.8	8.0					
SV3.5-6	1/4	6.4	12.1	28.3	12.1	13.0	6.7	1.0	黄 Yellow	导线截面: 4-6mm ² (美国线规12~10) 最大电流: 48A 材质: PVC和紫铜 镀层: 铜锡或亚锡 注: 易进式 (ESV), 加铜套 (C-SV) Cable size: 4-6mm ² Max current: I _{max} =48A Material: PVC+Copper Plating: Tin
SV 5.5-3.5	#6	3.7	7.5	26	8.4					
SVS 5.5-4	#8	4.3	7.5	26	8.4					
SVL 5.5-4	#8	4.3	7.5	26	9.0					
SV 5.5-5	#10	5.3	7.5	26	9.0					
SVS 5.5-6	1/4	6.4	7.5	26	9.0					
SVL 5.5-6	1/4	6.4	12.0	32	12.0					
SV 5.5-8	5/16	8.4	11.5	31	14.0					

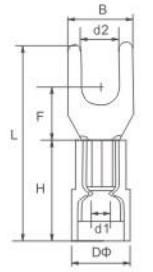

C-SV
(copper sleeve)

SPADE VINYL-INSULATED TERMINAL(TU-JTK) PVC绝缘叉形端头
EASY ENTRY AND COPPER SLEEVE (铜套)

型号 ITEM NO.	美制螺栓号 USA SCREW	螺栓口直径 Screw dia. d2φ(mm)	尺寸 Dimension(mm)						颜色 Color	说明 Explanation
			B	L	F	H	Dφ	T		
C-SV 1.25-3	#4	5.7	5.7	21.6	6.5	10.0	4.3	0.7	红 Red	导线截面: 0.5-1.5mm ² (美国线规22~16) 最大电流: 19A 材质: PVC和紫铜 镀层: 铜锡或亚锡 注: 加铜套 (C-SV) Cable size: 0.5-1.5mm ² Max current: I _{max} =19A Material: PVC+Copper Plating: Tin
C-SVS 1.25-3.5	#6	5.7	5.7	21.6	6.5					
C-SVL 1.25-3.5	#6	6.4	6.4	21.2	6.5					
C-SVS 1.25-4	#8	8.0	8.0	21.2	6.5					
C-SVM 1.25-4	#8	7.2	7.2	21.2	6.5					
C-SVL 1.25-4	#8	8.1	8.1	21.2	6.5					
C-SVS 1.25-5	#10	8.1	8.1	21.2	6.5					
C-SVL 1.25-5	#10	9.5	9.5	21.2	6.5					
C-SVS 1.25-6	1/4	9.5	9.5	21.2	6.5					
C-SVL 1.25-6	1/4	12.0	12.0	27.2	11.0					
C-SV 2-3	#4	3.2	6.5	21.6	5.7	10.6	4.9	0.8	蓝 Blue	导线截面: 1.5-2.5mm ² (美国线规16~14) 最大电流: 27A材质: PVC和紫铜 镀层: 铜锡或亚锡 注: 加铜套 (C-SV) Cable size: 1.5-2.5mm ² Max current: I _{max} =27A Material: PVC+Copper Plating: Tin
C-SVS 2-3.5	#6	3.7	6.5	21.2	5.7					
C-SVL 2-3.5	#6	3.7	6.5	21.2	6.0					
C-SVS 2-4	#8	4.3	6.5	21.2	6.4					
C-SVM 2-4	#8	4.3	6.5	21.2	7.2					
C-SVL 2-4	#8	4.3	6.5	21.2	8.1					
C-SVS 2-5	#10	5.3	6.5	21.2	8.1					
C-SVL 2-5	#10	5.3	6.5	21.2	9.5					
C-SVS 2-6	1/4	6.4	6.5	21.2	9.5					
C-SVL 2-6	1/4	6.4	11.0	27.8	12.0					
C-SV3.5-3	#4	3.2	7.0	26.8	5.7	13.0	6.2	1.0	黑 Black	Cable size: 2.5-4mm ² A.W.G: 14-12 Max current: I _{max} =37A Material: PVC+Copper Plating: Tin
C-SV3.5-4	#8	4.3	7.0	24.8	8.0					
C-SV3.5-5	#10	5.3	7.0	24.8	8.0					
C-SV3.5-6	1/4	6.4	12.1	28.3	12.1					
C-SV 5.5-3.5	#6	3.7	7.5	26	8.4	13.0	6.7	1.0	黄 Yellow	导线截面: 4-6mm ² (美国线规12~10) 最大电流: 48A 材质: PVC和紫铜 镀层: 铜锡或亚锡 注: 加铜套 (C-SV) Cable size: 4-6mm ² Max current: I _{max} =48A Material: PVC+Copper Plating: Tin
C-SVS 5.5-4	#8	4.3	7.5	26	8.4					
C-SVL 5.5-4	#8	4.3	7.5	26	9.0					
C-SV 5.5-5	#10	5.3	7.5	26	9.0					
C-SVS 5.5-6	1/4	6.4	7.5	26	9.0					
C-SVL 5.5-6	1/4	6.4	12.0	32	12.0					
C-SV 5.5-8	5/16	8.4	11.5	31	14.0					

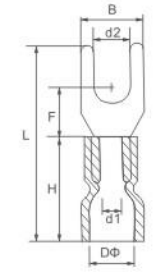

ESV
(easy entry)

SPADE VINYL-INSULATED TERMINAL(TU-JTK) PVC绝缘叉形端头
EASY ENTRY AND COPPER SLEEVE (易进式)

型号 ITEM NO.	美制螺栓号 USA SCREW	螺栓口直径 Screw dia. d2φ(mm)	尺寸 Dimension(mm)						颜色 Color	说明 Explanation
			B	L	F	H	Dφ	T		
ESV 1.25-3	#4	5.7	5.7	21.6	6.5	10.0	4.3	0.7	红 Red	导线截面: 0.5-1.5mm ² (美国线规22~16) 最大电流: 19A 材质: PVC和紫铜 镀层: 铜锡或亚锡 注: 易进式 (ESV) Cable size: 0.5-1.5mm ² Max current: I _{max} =19A Material: PVC+Copper Plating: Tin
ESVS 1.25-3.5	#6	5.7	5.7	21.6	6.5					
ESVL 1.25-3.5	#6	6.4	6.4	21.2	6.5					
ESVS 1.25-4	#8	8.0	8.0	21.2	6.5					
ESVM 1.25-4	#8	7.2	7.2	21.2	6.5					
ESVL 1.25-4	#8	8.1	8.1	21.2	6.5					
ESVS 1.25-5	#10	8.1	8.1	21.2	6.5					
ESVL 1.25-5	#10	9.5	9.5	21.2	6.5					
ESVS 1.25-6	1/4	9.5	9.5	21.2	6.5					
ESVL 1.25-6	1/4	12.0	12.0	27.2	11.0					
ESV 2-3	#4	3.2	6.5	21.6	5.7	10.6	4.9	0.8	蓝 Blue	导线截面: 1.5-2.5mm ² (美国线规16~14) 最大电流: 27A材质: PVC和紫铜 镀层: 铜锡或亚锡 注: 易进式 (ESV), 加铜套 (C-SV) Cable size: 1.5-2.5mm ² Max current: I _{max} =27A Material: PVC+Copper Plating: Tin
ESVS 2-3.5	#6	3.7	6.5	21.2	5.7					
ESVL 2-3.5	#6	3.7	6.5	21.2	6.0					
ESVS 2-4	#8	4.3	6.5	21.2	6.4					
ESVM 2-4	#8	4.3	6.5	21.2	7.2					
ESVL 2-4	#8	4.3	6.5	21.2	8.1					
ESVS 2-5	#10	5.3	6.5	21.2	8.1					
ESVL 2-5	#10	5.3	6.5	21.2	9.5					
ESVS 2-6	1/4	6.4	6.5	21.2	9.5					
ESVL 2-6	1/4	6.4	11.0	27.8	12.0					
ESV3.5-3	#4	3.2	7.0	26.8	5.7	13.0	6.2	1.0	黑 Black	Cable size: 2.5-4mm ² A.W.G: 14-12 Max current: I _{max} =37A Material: PVC+Copper Plating: Tin
ESV3.5-4	#8	4.3	7.0	24.8	8.0					
ESV3.5-5	#10	5.3	7.0	24.8	8.0					
ESV3.5-6	1/4	6.4	12.1	28.3	12.1					
ESV 5.5-3.5	#6	3.7	7.5	26	8.4	13.0	6.7	1.0	黄 Yellow	导线截面: 4-6mm ² (美国线规12~10) 最大电流: 48A 材质: PVC和紫铜 镀层: 铜锡或亚锡 注: 易进式 (ESV), 加铜套 (C-SV) Cable size: 4-6mm ² Max current: I _{max} =48A Material: PVC+Copper Plating: Tin
ESVS 5.5-4	#8	4.3	7.5	26	8.4					
ESVL 5.5-4	#8	4.3	7.5	26	9.0					
ESV 5.5-5	#10	5.3	7.5	26	9.0					
ESVS 5.5-6	1/4	6.4	7.5	26	9.0					
ESVL 5.5-6	1/4	6.4	12.0	32	12.0					
ESV 5.5-8	5/16	8.4	11.5	31	14.0					

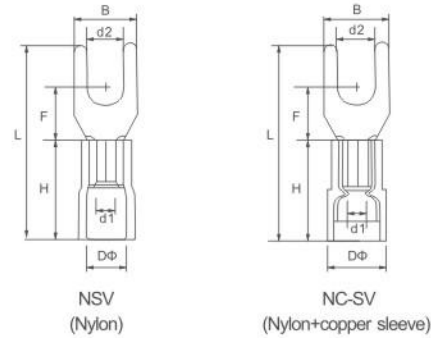

SPADE NYLON-INSULATED TERMINAL(Copper Seleeve) 尼龙绝缘叉形端头(加铜套)

SPADE NYLON-INSULATED TERMINAL (尼龙绝缘叉形端头)

型号 ITEM NO.	USA SCREW 美制螺栓号	螺栓口直径 Screw dia. d2Φ(mm)	尺寸 Dimension(mm)					颜色 Color	说明 Explanation	
			B	L	F	H	DΦ			
NSV 1.25-3	NC-SV 1.25-3	#4	5.7	5.7	21.6	6.5	10.0	4.3	红 Red	导线截面: 0.5-1.5mm ² (美国线规22~16) 最大电流: 19A 材质: 尼龙和紫铜 厚度: 0.7mm 镀层: 铜锡或亚锡 注: 尼龙 (NSV), 尼龙+铜套 (NC-SV) Cable size: 0.5-1.5mm ² (A.W.G22~16) Max current: I _{max} =19A Material: Nylon & Copper Thickness: 0.7mm Plating: Tin
NSVS 1.25-3.5	NC-SVS 1.25-3.5	#6	5.7	21.6	6.5					
NSVL 1.25-3.5	NC-SVL 1.25-3.5	#6	6.4	21.2	6.5					
NSVS 1.25-4	NC-SVS 1.25-4	#8	8.0	21.2	6.5					
NSVM 1.25-4	NC-SVM 1.25-4	#8	7.2	21.2	6.5					
NSVL 1.25-4	NC-SVL 1.25-4	#8	8.1	21.2	6.5					
NSVS 1.25-5	NC-SVS 1.25-5	#10	8.1	21.2	6.5					
NSVL 1.25-5	NC-SVL 1.25-5	#10	9.5	21.2	6.5					
NSVS 1.25-6	NC-SVS 1.25-6	1/4	9.5	21.2	6.5					
NSVL 1.25-6	NC-SVL 1.25-6	1/4	12.0	27.2	11.0					
NSV 2-3	NC-SV 2-3	#4	3.2	6.5	21.6	5.7	10.6	4.9	蓝 Blue	导线截面: 1.5-2.5mm ² (美国线规16~14) 最大电流: 27A 材质: 尼龙和紫铜 厚度: 0.8mm 镀层: 铜锡或亚锡 注: 尼龙 (NSV), 尼龙+铜套 (NC-SV) Cable size: 1.5-2.5mm ² (A.W.G16-14) Max current: I _{max} =27A Material: Nylon & Copper Thickness: 0.8mm Plating: Tin
NSVS 2-3.5	NC-SVS 2-3.5	#6	3.7	6.5	21.2	5.7				
NSVL 2-3.5	NC-SVL 2-3.5	#6	3.7	6.5	21.2	6.0				
NSVS 2-4	NC-SVS 2-4	#8	4.3	6.5	21.2	6.4				
NSVM 2-4	NC-SVM 2-4	#8	4.3	6.5	21.2	7.2				
NSVL 2-4	NC-SVL 2-4	#8	4.3	6.5	21.2	8.1				
NSVS 2-5	NC-SVS 2-5	#10	5.3	6.5	21.2	8.1				
NSVL 2-5	NC-SVL 2-5	#10	5.3	6.5	21.2	9.5				
NSVS 2-6	NC-SVS 2-6	1/4	6.4	6.5	21.2	9.5				
NSVL 2-6	NC-SVL 2-6	1/4	6.4	11.0	27.8	12.0				
NSV 5.5-3.5	NC-SV 5.5-3.5	#6	3.7	7.5	26	8.4	13.0	6.7	黄 Yellow	Cable size: 4-6mm ² (A.W.G12~10) Max current: I _{max} =48A Material: Nylon & Copper Thickness: 1.0mm Plating: Tin 导线截面: 4-6mm ² (美国线规12~10) 最大电流: 48A 材质: PVC和紫铜 厚度: 1.0mm 镀层: 铜锡或亚锡 注: 尼龙 (NSV), 尼龙+铜套 (NC-SV)
NSVS 5.5-4	NC-SVS 5.5-4	#8	4.3	7.5	26	8.4				
NSVL 5.5-4	NC-SVL 5.5-4	#8	4.3	7.5	26	9.0				
NSV 5.5-5	NC-SV 5.5-5	#10	5.3	7.5	26	9.0				
NSVS 5.5-6	NC-SVS 5.5-6	1/4	6.4	7.5	26	9.0				
NSVL 5.5-6	NC-SVL 5.5-6	1/4	6.4	12.0	32	12.0				
NSV 5.5-8	NC-SV 5.5-8	5/16	8.4	11.5	31	14.0				

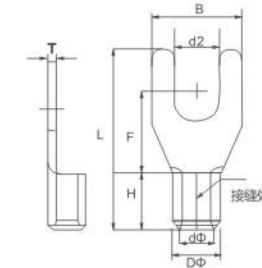

SPADE NON-INSULATED TERMINAL(TU) 叉形裸端头

型号 ITEM NO.	美制螺栓号 USA SCREW	d2Φ (mm)	尺寸 Dimension(mm)					E	DΦ	dΦ	说明 Explanation
			B	L	F						
SNB1.25-3	#4	3.2	5.7	16.0	6.5	4.8	3.4	1.7	导线截面: 0.5-1.5mm ² (美国线规22~16) 最大电流: 19A 材质: 紫铜 镀层: 锡 厚度: 0.7mm Cable size: 0.5-1.5mm ² (A.W.G22~16) Max current: I _{max} =27A Material: Copper Thickness: 0.7mm Plating: Tin		
SNBS1.25-3.5	#6	3.7	5.7	16.0	6.5						
SNBL1.25-3.5	#6	3.7	6.4	15.5	6.5						
SNBS1.25-4	#8	4.3	6.4	15.5	6.5						
SNBM1.25-4	#8	4.3	7.2	15.5	6.5						
SNBL1.25-4	#8	4.3	8.1	15.5	6.5						
SNBS1.25-5	#10	5.3	8.1	15.5	6.5						
SNBL1.25-5	#10	5.3	9.5	15.5	6.5						
SNBS1.25-6	1/4	6.4	9.5	15.5	6.5						
SNBL1.25-6	1/4	6.4	12.0	22.0	11.0						
SNB 2-3	#4	3.2	5.7	16.0	6.5	4.8	4.1	2.3	导线截面: 1.5-2.5mm ² (美国线规16~14) 最大电流: 27A 材质: 紫铜 厚度: 0.8mm 镀层: 锡 Cable size: 1.5-2.5mm ² (A.W.G16~14) Max current: I _{max} =27A Material: Copper Thickness: 0.8mm Plating: Tin		
SNBS 2-3.5	#6	3.7	5.7	16.0	6.5						
SNBL 2-3.5	#6	3.7	6.0	16.0	6.5						
SNBS 2-4	#8	4.3	6.4	16.0	6.5						
SNBM 2-4	#8	4.3	7.2	16.0	6.5						
SNBL 2-4	#8	4.3	8.1	16.0	6.5						
SNBS 2-5	#10	5.3	8.1	16.0	6.5						
SNBL 2-5	#10	5.3	9.5	16.0	6.5						
SNBS 2-6	1/4	6.4	9.5	16.0	6.5						
SNBL 2-6	1/4	6.4	12.0	22.0	11.0						
SNB 3.5-3	#4	3.2	5.7	18.3	7.0	6.0	5.0	3.0	Cable size: 2.5-4mm ² (A.W.G14~12) Max current: I _{max} =37A Material: Copper Thickness: 1.0mm Plating: Tin		
SNB 3.5-4	#8	4.3	8.0	18.3	7.0						
SNB 3.5-5	#10	5.3	8.0	18.3	7.0						
SNB 3.5-6	1/4	6.4	12.0	21.5	10.5						
SNB 5.5-3.5	#6	3.7	8.3	19.5	7.2	6.8	5.6	3.4	导线截面: 0.5-1.5mm ² (美国线规22~16) 最大电流: 19A 材质: 紫铜 镀层: 锡 Cable size: 4-6mm ² (A.W.G12~10) Max current: I _{max} =48A Material: Copper Thickness: 1.0mm Plating: Tin		
SNBS 5.5-4	#8	4.3	8.3	19.5	7.2						
SNBL 5.5-4	#8	4.3	9.0	19.5	7.5						
SNB 5.5-5	#10	5.3	9.0	19.5	7.5						
SNBS 5.5-6	1/4	6.4	9.0	19.5	7.2						
SNBL 5.5-6	1/4	6.4	12.0	25.5	12.0						
SNB 5.5-8	5/16	8.4	14.0	24.5	11.5						
SNB 8-4	#8	4.3	8.7	23.0	6.0					8.5	7.2
SNB 8-5	#10	5.3	12.0	24.5	5.7	8.5	7.2	4.5			
SNB 8-6	1/4	6.4	12.0	24.5	5.7	8.5	7.2	4.5			
SNB 8-8	5/16	8.4	14.5	28.0	8.3	8.5	7.2	4.5			
SNB 14-6	1/4	6.4	12.0	28.0	7.5	10.5	9.0	5.8			
SNB 14-8	5/16	8.4	14.0	28.0	7.5	10.5	9.0	5.8			
SNB 22-8	5/16	8.4	14.0	34.5	9.0	12.0	11.5	7.7			

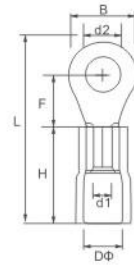

RV NRV

RING VINYL-INSULATED TERMINAL(TO-JTK) PVC绝缘圆形端头

型号 ITEM NO.	美制螺栓号 USA SCREW	螺栓口直径 Screw dia. d2Φ(mm)	尺寸 Dimension(mm)					颜色 Color	说明 Explanation
			B	L	F	H	DΦ		
RV1.25-3	#4	3.2	5.7	18.7	4.95	10.6	4.3	红 Red	导线截面: 0.5-1.5mm ² (美国线规22~16) 最大电流: 19A 材质: PVC和紫铜 厚度: 0.7mm 镀层: 铜锡或亚锡 注: 易进式 (ERV), 加铜套 (C-RV) Cable size: 0.5-1.5mm ² (AW.G22~16) Max current: I _{max} =19A Material: PVC+Copper Plating: Tin
RVS1.25-3.5	#6	3.7	5.7	18.7	4.95				
RVM1.25-3.5	#6	3.7	6.6	19.4	6.3				
RVL1.25-3.5	#6	3.7	8.0	21.2	7.0				
RVS1.25-4	#8	4.3	6.6	19.4	6.3				
RVL1.25-4	#8	4.3	8.0	21.2	7.0				
RVS1.25-5	#10	5.3	8.0	21.2	7.0				
RVL1.25-5	#10	5.3	9.8	23	8.5				
RVS1.25-6	1/4	6.4	9.8	23	8.5				
RVL1.25-6	1/4	6.4	11.6	26.8	11.1				
RV1.25-8	5/16	8.4	11.6	27.4	11.1				
RV1.25-10	3/8	10.5	13.6	27.4	13.9				
RV1.25-12	1/2	13.0	19.2	37.3	16.5				
RV 2-3	#4	3.2	6.6	17.5	4.3	10.6	4.9	蓝 Blue	导线截面: 1.5-2.5mm ² (美国线规16~14) 最大电流: 27A 材质: PVC和紫铜 厚度: 0.8mm 镀层: 铜锡或亚锡 注: 易进式 (ERV), 加铜套 (C-RV) Cable size: 1.5-2.5mm ² (A.W.G16~14) Max current: I _{max} =27A Material: PVC+Copper Plating: Tin
RVS 2-3.5	#6	3.7	6.6	17.5	4.3				
RVM 2-3.5	#8	3.7	6.6	20	6.2				
RVL 2-3.5	#6	3.7	8.5	22.8	7.75				
RVS 2-4	#8	4.3	6.6	20	6.2				
RVL 2-4	#8	4.3	8.5	22.8	7.75				
RVS 2-5	#10	5.3	8.5	22	7.75				
RVL 2-5	#10	5.3	9.5	22.6	7.25				
RVS 2-6	1/4	6.4	11.9	27.2	11.0				
RV 2-8	5/16	8.4	11.9	27.2	11.0				
RV 2-10	3/8	10.5	13.6	31.1	13.9				
RV 2-12	1/2	13.0	19.2	36.8	16.5				
RV 3.5-4	#8	4.3	8.0	24.5	7.7	13.5	6.2	黑 Black	Cable size: 2.5-4mm ² (AW.G14-12) Max current: I _{max} =37A Material: PVC+Copper Plating:Tin
RVS 3.5-5	#10	5.3	8.0	24.5	7.7				
RVL 3.5-5	#10	5.3	12.0	29	7.7				
RV 3.5-6	1/4	6.4	12.0	29	7.7	13.5	6.7	黄 Yellow	导线截面: 4-6mm ² (美国线规12~10) 最大电流: 48A 材质: PVC和紫铜 厚度: 1.0mm 镀层: 铜锡或亚锡 注: 易进式 (ERV), 加铜套 (C-RV) Cable size: 4-6mm ² (A.W.G12~10) Max current: I _{max} =48A Material: PVC+Copper Plating:Tin
RV 5.5-3.5	#6	3.7	7.2	22	5.3				
RVS 5.5-4	#8	4.3	7.2	22	5.3				
RVL 5.5-4	#8	4.3	9.5	26.2	8.25				
RV 5.5-5	#10	5.3	9.5	26.2	8.25				
RVS 5.5-6	1/4	6.4	12.0	32.1	10.7				
RVL 5.5-6	1/4	6.4	12.0	32.8	13				
RV 5.5-8	5/16	8.4	15.0	34	13.7				
RV 5.5-10	3/8	10.5	15.0	34	13.7				
RV 5.5-12	1/2	13.0	19.2	38.8	16				

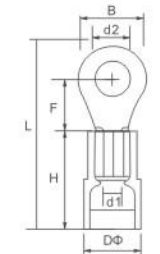

C-RV
(copper sleeve)

RING VINYL-INSULATED TERMINAL PVC 绝缘圆形端头 EASY ENTRY AND COPPER SLEEVE (铜套)

型号 ITEM NO.	美制螺栓号 USA SCREW	螺栓口直径 Screw dia. d2Φ(mm)	尺寸 Dimension(mm)					颜色 Color	说明 Explanation
			B	L	F	H	DΦ		
C-RV1.25-3	#4	3.2	5.7	18.7	4.95	10.6	4.3	红 Red	导线截面: 0.5-1.5mm ² (美国线规22~16) 最大电流: 19A 材质: PVC和紫铜 厚度: 0.7mm 镀层: 铜锡或亚锡 注: 加铜套 (C-RV) Cable size: 0.5-1.5mm ² (AW.G22~16) Max current: I _{max} =19A Material: PVC+Copper Plating: Tin
C-RVS1.25-3.5	#6	3.7	5.7	18.7	4.95				
C-RVM1.25-3.5	#6	3.7	6.6	19.4	6.3				
C-RVL1.25-3.5	#6	3.7	8.0	21.2	7.0				
C-RVS1.25-4	#8	4.3	6.6	19.4	6.3				
C-RVL1.25-4	#8	4.3	8.0	21.2	7.0				
C-RVS1.25-5	#10	5.3	8.0	21.2	7.0				
C-RVL1.25-5	#10	5.3	9.8	23	8.5				
C-RVS1.25-6	1/4	6.4	9.8	23	8.5				
C-RVL1.25-6	1/4	6.4	11.6	26.8	11.1				
C-RV1.25-8	5/16	8.4	11.6	27.4	11.1				
C-RV1.25-10	3/8	10.5	13.6	27.4	13.9				
C-RV1.25-12	1/2	13.0	19.2	37.3	16.5				
C-RV 2-3	#4	3.2	6.6	17.5	4.3	10.6	4.9	蓝 Blue	导线截面: 1.5-2.5mm ² (美国线规16~14) 最大电流: 27A 材质: PVC和紫铜 厚度: 0.8mm 镀层: 铜锡或亚锡 注: 加铜套 (C-RV) Cable size: 1.5-2.5mm ² (A.W.G16~14) Max current: I _{max} =27A Material: PVC+Copper Plating: Tin
C-RVS 2-3.5	#6	3.7	6.6	17.5	4.3				
C-RVM 2-3.5	#8	3.7	6.6	20	6.2				
C-RVL 2-3.5	#6	3.7	8.5	22.8	7.75				
C-RVS 2-4	#8	4.3	6.6	20	6.2				
C-RVL 2-4	#8	4.3	8.5	22.8	7.75				
C-RVS 2-5	#10	5.3	8.5	22	7.75				
C-RVL 2-5	#10	5.3	9.5	22.6	7.25				
C-RVS 2-6	1/4	6.4	11.9	27.2	11.0				
C-RV 2-8	5/16	8.4	11.9	27.2	11.0				
C-RV 2-10	3/8	10.5	13.6	31.1	13.9				
C-RV 2-12	1/2	13.0	19.2	36.8	16.5				
C-RV 3.5-4	#8	4.3	8.0	24.5	7.7	13.5	6.2	黑 Black	Cable size: 2.5-4mm ² (AW.G14-12) Max current: I _{max} =37A Material: PVC+Copper Plating:Tin
C-RVS 3.5-5	#10	5.3	8.0	24.5	7.7				
C-RVL 3.5-5	#10	5.3	12.0	29	7.7				
C-RV 3.5-6	1/4	6.4	12.0	29	7.7	13.5	6.7	黄 Yellow	导线截面: 4-6mm ² (美国线规12~10) 最大电流: 48A 材质: PVC和紫铜 厚度: 1.0mm 镀层: 铜锡或亚锡 注: 加铜套 (C-RV) Cable size: 4-6mm ² (A.W.G12~10) Max current: I _{max} =48A Material: PVC+Copper Plating:Tin
C-RV 5.5-3.5	#6	3.7	7.2	22	5.3				
C-RVS 5.5-4	#8	4.3	7.2	22	5.3				
C-RVL 5.5-4	#8	4.3	9.5	26.2	8.25				
C-RV 5.5-5	#10	5.3	9.5	26.2	8.25				
C-RVS 5.5-6	1/4	6.4	12.0	32.1	10.7				
C-RVL 5.5-6	1/4	6.4	12.0	32.8	13				
C-RV 5.5-8	5/16	8.4	15.0	34	13.7				
C-RV 5.5-10	3/8	10.5	15.0	34	13.7				
C-RV 5.5-12	1/2	13.0	19.2	38.8	16				

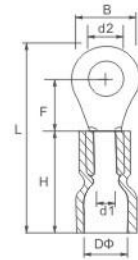

ERV
(easy entry)

RING VINYL-INSULATED TERMINAL PVC 绝缘圆形端头
EASY ENTRY AND COPPER SLEEVE (易进式)

型号 ITEM NO.	美制螺栓号 USA SCREW	螺栓口直径 Screw dia. d2φ(mm)	尺寸 Dimension(mm)					颜色 Color	说明 Explanation
			B	L	F	H	Dφ		
ERV1.25-3	#4	3.2	5.7	18.7	4.95	10.6	4.3	红 Red	导线截面: 0.5-1.5mm ² (美国线规22~16) 最大电流: 19A 材质: PVC和紫铜 厚度: 0.7mm 镀层: 铜锡或亚锡 注: 易进式(ERV) Cable size: 0.5-1.5mm ² (A.W.G22~16) Max current: I _{max} =19A Material: PVC+Copper Plating: Tin
ERVS1.25-3.5	#6	3.7	5.7	18.7	4.95				
ERVM1.25-3.5	#6	3.7	6.6	19.4	6.3				
ERVL1.25-3.5	#6	3.7	8.0	21.2	7.0				
ERVS1.25-4	#8	4.3	6.6	19.4	6.3				
ERVL1.25-4	#8	4.3	8.0	21.2	7.0				
ERVS1.25-5	#10	5.3	8.0	21.2	7.0				
ERVL1.25-5	#10	5.3	9.8	23	8.5				
ERVS1.25-6	1/4	6.4	9.8	23	8.5				
ERVL1.25-6	1/4	6.4	11.6	26.8	11.1				
ERV1.25-8	5/16	8.4	11.6	27.4	11.1				
ERV1.25-10	3/8	10.5	13.6	27.4	13.9				
ERV1.25-12	1/2	13.0	19.2	37.3	16.5				
ERV 2-3	#4	3.2	6.6	17.5	4.3	10.6	4.9	蓝 Blue	导线截面: 1.5-2.5mm ² (美国线规16~14) 最大电流: 27A 材质: PVC和紫铜 厚度: 0.8mm 镀层: 铜锡或亚锡 注: 易进式(ERV) Cable size: 1.5-2.5mm ² (A.W.G16~14) Max current: I _{max} =27A Material: PVC+Copper Plating: Tin
ERVS 2-3.5	#6	3.7	6.6	17.5	4.3				
ERVM 2-3.5	#8	3.7	6.6	20	6.2				
ERVL 2-3.5	#6	3.7	8.5	22.8	7.75				
ERVS 2-4	#8	4.3	6.6	20	6.2				
ERVL 2-4	#8	4.3	8.5	22.8	7.75				
ERVS 2-5	#10	5.3	8.5	22	7.75				
ERVL 2-5	#10	5.3	9.5	22.6	7.25				
ERVS 2-6	1/4	6.4	11.9	27.2	11.0				
ERV 2-8	5/16	8.4	11.9	27.2	11.0				
ERV 2-10	3/8	10.5	13.6	31.1	13.9				
ERV 2-12	1/2	13.0	19.2	36.8	16.5				
ERV 3.5-4	#8	4.3	8.0	24.5	7.7	13.5	6.2	黑 Black	Cable size: 2.5-4mm ² (A.W.G14-12) Max current: I _{max} =37A Material: PVC+Copper Plating: Tin
ERVS 3.5-5	#10	5.3	8.0	24.5	7.7				
ERVL 3.5-5	#10	5.3	12.0	29	7.7				
ERV 3.5-6	1/4	6.4	12.0	29	7.7	13.5	6.7	黄 Yellow	导线截面: 4-6mm ² (美国线规12~10) 最大电流: 48A 材质: PVC和紫铜 厚度: 1.0mm 镀层: 铜锡或亚锡 注: 易进式(ERV) Cable size: 4-6mm ² (A.W.G12~10) Max current: I _{max} =48A Material: PVC+Copper Plating: Tin
ERV 5.5-3.5	#6	3.7	7.2	22	5.3				
ERVS 5.5-4	#8	4.3	7.2	22	5.3				
ERVL 5.5-4	#8	4.3	9.5	26.2	8.25				
ERV 5.5-5	#10	5.3	9.5	26.2	8.25				
ERVS 5.5-6	1/4	6.4	12.0	32.1	10.7				
ERVL 5.5-6	1/4	6.4	12.0	32.8	13				
ERV 5.5-8	5/16	8.4	15.0	34	13.7				
ERV 5.5-10	3/8	10.5	15.0	34	13.7				
ERV 5.5-12	1/2	13.0	19.2	38.8	16				

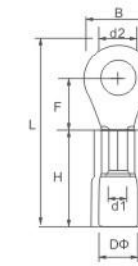

NRV
(Nylon)

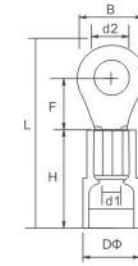

NC-RV
(Nylon+copper sleeve)

RING NYLON-INSULATED TERMINAL (Copper Sleeve) 尼龙绝缘圆形端头(加铜套)
RING NYLON-INSULATED TERMINAL (尼龙绝缘圆形端头)

型号 ITEM NO.		美制螺栓号 USA SCREW	螺栓口直径 Screw dia. d2φ(mm)	尺寸 Dimension(mm)					颜色 Color	说明 Explanation
				B	L	F	H	Dφ		
NRV1.25-3	NC-RV1.25-3	#4	3.2	5.7	18.7	4.95	10.6	4.3	红 Red	导线截面: 0.5-1.5mm ² (美国线规22~16) 最大电流: 19A 材质: 尼龙和紫铜 厚度: 0.7mm 镀层: 铜锡或亚锡 注: 尼龙(NRV), 尼龙+铜套(NC-RV) Cable size: 0.5-1.5mm ² (A.W.G22~16) Max current: I _{max} =19A Material: Nylon & Copper Thickness: 0.7mm Plating: Tin
NRVS1.25-3.5	NC-RVS1.25-3.5	#6	3.7	5.7	18.7	4.95				
NRVM1.25-3.5	NC-RVM1.25-3.5	#6	3.7	6.6	19.4	6.3				
NRVL1.25-3.5	NC-RVL1.25-3.5	#6	3.7	8.0	21.2	7.0				
NRVS1.25-4	NC-RVS1.25-4	#8	4.3	6.6	19.4	6.3				
NRVL1.25-4	NC-RVL1.25-4	#8	4.3	8.0	21.2	7.0				
NRVS1.25-5	NC-RVS1.25-5	#10	5.3	8.0	21.2	7.0				
NRVL1.25-5	NC-RVL1.25-5	#10	5.3	9.8	23	8.5				
NRVS1.25-6	NC-RVS1.25-6	1/4	6.4	9.8	23	8.5				
NRVL1.25-6	NC-RVL1.25-6	1/4	6.4	11.6	26.8	11.1				
NRV1.25-8	NC-RV1.25-8	5/16	8.4	11.6	27.4	11.1				
NRV1.25-10	NC-RV1.25-10	3/8	10.5	13.6	27.4	13.9				
NRV1.25-12	NC-RV1.25-12	1/2	13.0	19.2	37.3	16.5				
NRV 2-3	NC-RV 2-3	#4	3.2	6.6	17.5	4.3	10.6	4.9	蓝 Blue	导线截面: 1.5-2.5mm ² (美国线规16~14) 最大电流: 27A 材质: 尼龙和紫铜 厚度: 0.8mm 镀层: 铜锡或亚锡 注: 尼龙(NRV), 尼龙+铜套(NC-RV) Cable size: 1.5-2.5mm ² (A.W.G16-14) Max current: I _{max} =27A Material: Nylon & Copper Thickness: 0.8mm Plating: Tin
NRVS 2-3.5	NC-RVS 2-3.5	#6	3.7	6.6	17.5	4.3				
NRVM 2-3.5	NC-RVM 2-3.5	#8	3.7	6.6	20	6.2				
NRVL 2-3.5	NC-RVL 2-3.5	#6	3.7	8.5	22.8	7.75				
NRVS 2-4	NC-RVS 2-4	#8	4.3	6.6	20	6.2				
NRVL 2-4	NC-RVL 2-4	#8	4.3	8.5	22.8	7.75				
NRVS 2-5	NC-RVS 2-5	#10	5.3	8.5	22	7.75				
NRVL 2-5	NC-RVL 2-5	#10	5.3	9.5	22.6	7.25				
NRVS 2-6	NC-RVS 2-6	1/4	6.4	11.9	27.2	11.0				
NRV 2-8	NC-RV 2-8	5/16	8.4	11.9	27.2	11.0				
NRV 2-10	NC-RV 2-10	3/8	10.5	13.6	31.1	13.9				
NRV 2-12	NC-RV 2-12	1/2	13.0	19.2	36.8	16.5				
NRV 5.5-3.5	NC-RV 5.5-3.5	#6	3.7	7.2	22	5.3	13.5	6.7	黄 Yellow	导线截面: 4-6mm ² (美国线规12~10) 最大电流: 48A 材质: PVC和紫铜 厚度: 1.0mm 镀层: 铜锡或亚锡 注: 尼龙(NRV), 尼龙+铜套(NC-RV) Cable size: 4-6mm ² (A.W.G12~10) Max current: I _{max} =48A Material: Nylon & Copper Thickness: 1.7mm Plating: Tin
NRVS 5.5-4	NC-RVS 5.5-4	#8	4.3	7.2	22	5.3				
NRVL 5.5-4	NC-RVL 5.5-4	#8	4.3	9.5	26.2	8.25				
NRV 5.5-5	NC-RV 5.5-5	#10	5.3	9.5	26.2	8.25				
NRVS 5.5-6	NC-RVS 5.5-6	1/4	6.4	12.0	32.1	10.7				
NRVL 5.5-6	NC-RVL 5.5-6	1/4	6.4	12.0	32.8	13				
NRV 5.5-8	NC-RV 5.5-8	5/16	8.4	15.0	34	13.7				
NRV 5.5-10	NC-RV 5.5-10	3/8	10.5	15.0	34	13.7				
NRV 5.5-12	NC-RV 5.5-12	1/2	13.0	19.2	38.8	16				

RING NON-INSULATED TERMINAL(TO) 圆形裸端头

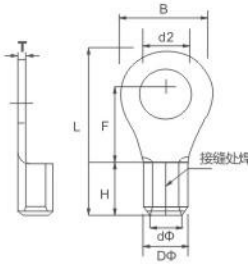

型号 ITEM NO.	美制螺栓号 USA SCREW	d2Φ (mm)	尺寸 Dimension(mm)						说明 Explanation
			B	L	F	E	DΦ	dΦ	
RNB1.25-3	#4	3.2	5.7	12.6	4.95	4.8	3.4	1.7	导线截面: 0.5-1.5mm ² (美国线规22~16) 最大电流: 19A 材质: 紫铜 镀层: 锡 Cable size: 0.5-1.5mm ² (A.W.G22~16) Max current: I _{max} =19A Material: Copper Plating: Tin
RNBS1.25-3.5	#6	3.7	5.7	12.6	4.95				
RNBM1.25-3.5	#6	3.7	6.6	14.4	6.3				
RNBL1.25-3.5	#6	3.7	8.0	15.8	7.0				
RNBS1.25-4	#8	4.3	6.6	14.4	6.3				
RNBL1.25-4	#8	4.3	8.0	15.8	7.0				
RNBS1.25-5	#10	5.3	8.0	15.8	7.0				
RNBL1.25-5	#10	5.3	9.8	18.0	8.3				
RNBS1.25-6	1/4	6.4	9.8	18.8	8.3				
RNBL1.25-6	1/4	6.4	11.6	21.8	11.2				
RNB1.25-8	5/16	8.4	11.6	21.8	11.2				
RNB1.25-10	3/8	10.5	13.6	25.5	13.9				
RNB1.25-12	1/2	13.0	19.2	31.0	16.5				
RNB 2-3	#4	3.2	6.6	12.3	4.2	4.8	4.1	2.3	导线截面: 1.5-2.5mm ² (美国线规16~14) 最大电流: 27A 材质: 紫铜 镀层: 锡 Cable size: 1.5-2.5mm ² (A.W.G16~14) Max current: I _{max} =27A Material: Copper Plating: Tin
RNBS 2-3.5	#6	3.7	6.6	12.3	4.2				
RNBM 2-3.5	#6	3.7	6.6	16.0	7.9				
RNBL 2-3.5	#6	3.7	8.5	16.8	7.75				
RNBS 2-4	#8	4.3	6.6	16.0	7.9				
RNBL 2-4	#8	4.3	8.5	16.8	7.75				
RNBS 2-5	#10	5.3	8.5	16.8	7.75				
RNBL 2-5	#10	5.3	9.5	16.8	7.25				
RNB 2-6	1/4	6.4	12.0	21.8	11.0				
RNB 2-8	5/16	6.4	12.0	21.8	11.0				
RNB 2-10	3/8	10.5	13.6	25.5	13.9				
RNB 2-12	1/2	13.0	19.2	31.0	16.5				
RNB 3.5-4	#8	4.3	8.0	18.0	7.7	6.0	5.0	3.0	Cable size: 2.5-4mm ² (A.W.G14~12) Max current: I _{max} =37A Material: Copper Plating: Tin
RNBS 3.5-5	#10	5.3	8.0	18.0	7.7				
RNBL 3.5-5	#10	5.3	12.0	21.4	7.7				
RNB 3.5-6	1/4	6.4	12.0	21.4	7.7				
RNB 5.5-3.5	#6	3.7	7.2	15.7	5.3	6.8	5.6	3.4	导线截面: 4-6mm ² (美国线规12~10) 最大电流: 48A 材质: 紫铜 镀层: 锡 Cable size: 4-6mm ² (A.W.G12~10) Max current: I _{max} =48A Material: Copper Plating: Tin
RNBS 5.5-4	#8	4.3	7.2	15.7	5.3				
RNBL 5.5-4	#8	4.3	9.5	19.8	8.25				
RNB 5.5-5	#10	5.3	9.5	19.8	8.25				
RNBS 5.5-6	1/4	6.4	12.0	23.35	10.7				
RNBL 5.5-6	1/4	6.4	12.0	25.8	13.0				
RNB 5.5-8	5/16	8.4	15.0	28.0	13.7				
RNB 5.5-10	3/8	10.5	15.0	28.0	13.7				
RNB 5.5-12	1/2	13.0	19.2	32.4	16.0				

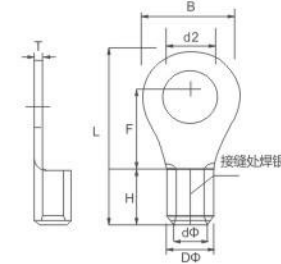

RING NON-INSULATED TERMINAL(TO) 圆形裸端子

型号 ITEM NO.	美制螺栓号 USA SCREW	d2Φ (mm)	尺寸 Dimension(mm)						说明 Explanation				
			B	L	F	E	DΦ	dΦ					
RNB 8-4	#8	4.3	8.8	23.8	9.3	8.5	7.2	4.5	导线截面: 6-10mm ² (美国线规8) 最大电流: 62A 材质: 紫铜 厚度: 1.2mm 镀层: 锡 Cable size: 6-10mm ² (A.W.G8) Max current: I _{max} =62A Material: Copper Thickness: 1.2mm Plating: Tin				
RNBS 8-5	#10	5.3	8.8	23.8	11.1								
RNBM 8-5	#10	5.3	12.0	23.8	9.3								
RNBL 8-5	#10	5.3	15.0	29.8	13.8								
RNBS 8-6	1/4	6.4	12.0	23.8	9.3								
RNBL 8-6	1/4	6.4	15.0	29.8	13.8								
RNB 8-8	5/16	8.4	15.0	29.8	13.8								
RNB 8-10	3/8	10.5	15.0	29.8	13.8								
RNB 8-12	1/2	13.0	20.0	33.5	15.0								
RNB 14-4	#8	4.3	12.0	29.8	13.3					10.5	9.5	5.8	导线截面: 10-16mm ² (美国线规6) 最大电流: 88A 材质: 紫铜 厚度: 1.4mm 镀层: 锡 Cable size: 10-16mm ² (A.W.G6) Max current: I _{max} =88A Material: Copper Thickness: 1.4mm Plating: Tin
RNBS 14-6	1/4	6.4	12.0	29.8	13.3								
RNBL 14-6	1/4	6.4	16.0	32.8	13.3								
RNB 14-8	5/16	8.4	16.0	31.8	13.3								
RNB 14-10	3/8	10.5	16.0	31.8	13.3								
RNB 14-12	1/2	13.0	22.0	41.0	19.5								
RNBS 22-5	#10	4.3	12.2	33.2	15.1	12.0	11.5	7.7	导线截面: 16-25mm ² (美国线规4) 最大电流: 115A 材质: 紫铜 厚度: 1.4mm 镀层: 锡 Cable size: 16-25mm ² (A.W.G4) Max current: I _{max} =115A Material: Copper Thickness: 1.4mm Plating: Tin				
RNBL 22-5	#10	5.3	16.5	33.7	13.5								
RNBS 22-6	1/4	6.4	12.2	33.2	15.1								
RNBL 22-6	1/4	6.4	16.5	33.7	13.5								
RNB 22-8	5/16	8.4	16.5	33.7	13.5								
RNB 22-10	3/8	10.5	16.5	33.7	13.5								
RNB 22-11	7/16	11.5	22.0	42.5	19.5								
RNB 22-12	1/2	13.0	22.0	42.5	19.5								
RNB 38-5	#10	5.3	15.3	39.0	17.4					14.0	13.3	9.4	导线截面: 35-50mm ² (美国线规2) 最大电流: 160A 材质: 紫铜 厚度: 1.8mm 镀层: 锡 Cable size: 35-50mm ² (A.W.G2) Max current: I _{max} =160A Material: Copper Thickness: 1.8mm Plating: Tin
RNB 38-6	1/4	6.4	15.3	39.0	17.4								
RNBS 38-8	5/16	8.4	15.3	39.0	17.4								
RNBL 38-8	5/16	8.4	22.0	42.7	17.7								
RNBS 38-10	3/8	10.5	15.3	39.0	17.4								
RNBL 38-10	3/8	10.5	22.0	42.7	17.7								
RNB 38-11	7/16	11.5	22.0	42.7	17.7								
RNB 38-12	1/2	13.0	22.0	42.7	17.7								

RING NON-INSULATED TERMINAL(TO) 圆形裸端头



型号 ITEM NO.	美制螺栓号 USA SCREW	d2Φ (mm)	尺寸 Dimension(mm)						说明 Explanation
			B	L	F	E	DΦ	dΦ	
RNB 60-6	1/4	6.4	22.0	49.7	20.7	18.0	15.4	11.4	导线截面: 50-70mm ² (美国线规1/0) 最大电流: 215A 材质: 紫铜 厚度: 1.8mm 镀层: 锡
RNB 60-8	5/16	8.4							
RNB 60-10	3/8	10.5							
RNB 60-11	7/16	11.5							
RNB 60-12	1/2	13.0							
RNB 60-14	9/16	15.0							
RNB 60-16	5/8	17.0	32.0	57.5	23.5	19.0	17.5	13.3	Cable size: 50-70mm ² (A.W.G1/0) Max current: I _{max} =215A Material: Copper Thickness: 1.8mm Plating: Tin
RNB 60-18	11/16	19.0							
RNB 60-20	3/4	21.0							
RNB 60-22	7/8	23.0							
RNB 70-6	1/4	6.4							
RNB 70-8	5/16	8.4							
RNB 70-10	3/8	10.5	24.0	51.0	20.0	19.0	17.5	13.3	导线截面: 70-95mm ² (美国线规2/0) 最大电流: 235A 材质: 紫铜 厚度: 2.0mm 镀层: 锡
RNB 70-11	7/16	11.5							
RNB 70-12	1/2	13.0							
RNB 70-14	9/16	15.0							
RNB 70-16	5/8	17.0							
RNB 70-18	11/16	19.0							
RNB 70-20	3/4	21.0	32.0	61.0	26.0	20.0	19.5	14.5	Cable size: 70-95mm ² (A.W.G2/0) Max current: I _{max} =235A Material: Copper Thickness: 2.0mm Plating: Tin
RNB 70-22	7/8	23.0							
RNB 80-6	1/4	6.4							
RNB 80-8	5/16	8.4							
RNB 80-10	3/8	10.5							
RNB 80-11	7/16	11.5							
RNB 80-12	1/2	13.0	27.0	54.2	20.7	20.0	19.5	14.5	导线截面: 95-120mm ² (美国线规3/0) 最大电流: 255A 材质: 紫铜 厚度: 2.2mm 镀层: 锡
RNB 80-14	9/16	15.0							
RNB 80-16	5/8	17.0							
RNB 80-18	11/16	19.0							
RNB 80-20	3/4	21.0							
RNB 80-22	7/8	23.0							
RNB 100-6	1/4	6.4	28.5	55.6	20.4	21.0	22.1	16.4	Cable size: 95-120mm ² (A.W.G3/0) Max current: I _{max} =255A Material: Copper Thickness: 2.2mm Plating: Tin
RNB 100-8	5/16	8.4							
RNB 100-10	3/8	10.5							
RNB 100-11	7/16	11.5							
RNB 100-12	1/2	13.0							
RNB 100-14	9/16	15.0							
RNB 100-16	5/8	17.0	32.0	69.0	32.0	21.0	22.1	16.4	Cable size: 120-150mm ² (美国线规4/0) 最大电流: 300A 材质: 紫铜 厚度: 2.5mm 镀层: 锡
RNB 100-18	11/16	19.0							
RNB 100-20	3/4	21.0							
RNB 100-22	7/8	23.0							
RNB 100-14	9/16	15.0							
RNB 100-16	5/8	17.0							
RNB 100-18	11/16	19.0							
RNB 100-20	3/4	21.0							
RNB 100-22	7/8	23.0							

RING NON-INSULATED TERMINAL(TO) 圆形裸端头



型号 ITEM NO.	美制螺栓号 USA SCREW	d2Φ (mm)	尺寸 Dimension(mm)						说明 Explanation
			B	L	F	E	DΦ	dΦ	
RNB 150-8	5/16	8.4	36.0	66.0	23.0	27.0	26.6	19.5	导线截面: 150-185mm ² (美国线规250/300MCM) 最大电流: 395A 材质: 紫铜 厚度: 3.2mm 镀层: 锡
RNB 150-10	3/8	10.5							
RNB 150-11	7/16	11.5							
RNB 150-12	1/2	13.0							
RNB 150-14	9/16	15.0							
RNB 150-16	5/8	17.0							
RNB 150-18	11/16	19.0	36.0	81.0	36.0	28.5	28.6	21.0	Cable size: 150-185mm ² (A.W.G250/300MCM) Max current: I _{max} =395A Material: Copper Thickness: 3.2mm Plating: Tin
RNB 150-20	3/4	21.0							
RNB 150-22	7/8	23.0							
RNB 150-24	15/16	25.0							
RNB 150-27	1	28.0							
RNB 180-8	5/16	8.4							
RNB 180-10	3/8	10.5	38.5	69.0	24.5	28.5	28.6	21.0	导线截面: 185-240mm ² (美国线规300/350MCM) 最大电流: 440A 材质: 紫铜 厚度: 3.5mm 镀层: 锡
RNB 180-11	7/16	11.5							
RNB 180-12	1/2	13.0							
RNB 180-14	9/16	15.0							
RNB 180-16	5/8	17.0							
RNB 180-18	11/16	19.0							
RNB 180-20	3/4	21.0	38.5	86.6	39.5	31.5	32.6	24.0	Cable size: 185-240mm ² (A.W.G300/350MCM) Max current: I _{max} =440A Material: Copper Thickness: 3.5mm Plating: Tin
RNB 180-22	7/8	23.0							
RNB 180-24	15/16	25.0							
RNB 180-27	1	28.0							
RNB 200-8	5/16	8.4							
RNB 200-10	3/8	10.5							
RNB 200-11	7/16	11.5	44.0	72.0	24.5	44.0	91.0	37.5	导线截面: 240-300mm ² (美国线规400/500MCM) 最大电流: 470A 材质: 紫铜 厚度: 4mm 镀层: 锡
RNB 200-12	1/2	13.0							
RNB 200-14	9/16	15.0							
RNB 200-16	5/8	17.0							
RNB 200-18	11/16	19.0							
RNB 200-20	3/4	21.0							
RNB 200-22	7/8	23.0	44.0	91.0	37.5	50.5	88.0	33.5	Cable size: 240-300mm ² (A.W.G400/500MCM) Max current: I _{max} =470A Material: Copper Thickness: 4.0mm Plating: Tin
RNB 200-24	15/16	25.0							
RNB 200-27	1	28.0							
RNB 325-8	5/16	8.4							
RNB 325-10	3/8	10.5							
RNB 325-11	7/16	11.5							
RNB 325-12	1/2	13.0							
RNB 325-14	9/16	15.0							
RNB 325-16	5/8	17.0							
RNB 325-18	11/16	19.0							
RNB 325-20	3/4	21.0							
RNB 325-22	7/8	23.0	50.5	105.6	45.5	35.5	37.1	28.0	Cable size: 300-400mm ² (A.W.G500/600MCM) Max current: I _{max} =650A Material: Copper Thickness: 4.0mm Plating: Tin
RNB 325-24	15/16	25.0							
RNB 325-27	1	28.0							

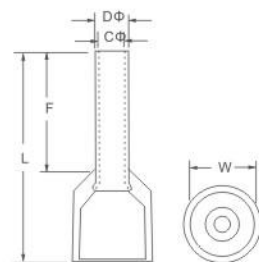

INSULATED CORD END TERMINAL(TG-JT) 管形预绝缘端头

型号 ITEM NO.		尺寸 Dimension(mm)						导体截面积 Conductor section (mm ²)	Color 绝缘护套颜色 (1) German 德国用 (2) French 法国用	
PVC	NYLON	F	L	W	DΦ	CΦ	A.W.G			
E 0506	NE 0506	6.0	12.0	3.4	1.3	1.0	#22	0.5	Orange 橙色 (1)	
E 0508	NE 0508	8.0	14.0						White 白色 (2)	
E 0510	NE 0510	10.0	16.0							
E 0512	NE 0512	12.0	18.0							
E 7506	NE 7506	6.0	12.4	3.4	1.5	1.2	#20	0.75	White 白色 (1)	
E 7508	NE 7508	8.0	14.4						Blue 蓝色 (2)	
E 7510	NE 7510	10.0	16.4							
E 7512	NE 7512	12.0	18.4							
E 1006	NE 1006	6.0	12.5	3.6	1.7	1.4	#18	1.0	Yellow 黄色 (1)	
E 1008	NE 1008	8.0	14.5						Red 红色 (2)	
E 1010	NE 1010	10.0	16.5							
E 1012	NE 1012	12.0	18.5							
E 1508	NE 1508	8.0	15.4	4.0	2.0	1.7	#16	1.5	Red 红色 (1)	
E 1510	NE 1510	10.0	17.4						Black 黑色 (2)	
E 1512	NE 1512	12.0	19.4							
E 1518	NE 1518	18.0	25.4							
E 2508	NE 2508	8.0	15.0	4.6	2.6	2.3	#14	2.5	Blue 蓝色 (1)	
E 2510	NE 2510	10.0	17.0						Gray 灰色 (2)	
E 2512	NE 2512	12.0	19.0							
E 2518	NE 2518	18.0	25.0							
E 4009	NE 4009	9.0	17.0	5.5	3.2	2.8	#12	4.0	Gray 灰色 (1)	
E 4012	NE 4012	12.0	21.0						Orange 橙色 (2)	
E 4018	NE 4018	18.0	27.0							

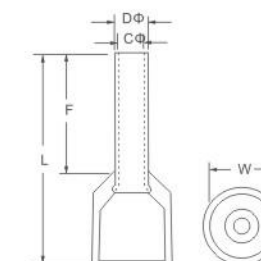

INSULATED CORD END TERMINAL(TG-JT) 管形预绝缘端头

型号 ITEM NO.		尺寸 Dimension(mm)						导体截面积 Conductor section (mm ²)	Color 绝缘护套颜色 (1) German 德国用 (2) French 法国用	
PVC	NYLON	F	L	W	DΦ	CΦ	A.W.G			
E 6010	NE 6010	10.0	19.0	6.7	3.9	3.5	#10	6.0	Black 黑色 (1)	
E 6012	NE 6012	12.0	21.0						Green 绿色 (2)	
E 6018	NE 6018	18.0	26.0							
E 10-12	NE 10-12	12.0	20.8	8.3	4.9	4.5	#7	10.0	Ivory 乳白 (1)	
E 10-18	NE 10-18	18.0	26.8						Brown 褐(棕色) (2)	
E 16-12	NE 16-12	12.0	22.2	9.4	6.2	5.8	#5	16.0	Green 绿色 (1)	
E 16-18	NE 16-18	18.0	27.6						Ivory 乳白 (2)	
E 25-16	NE 25-16	16.0	27.6	11.7	7.9	7.5	#4	25.0	Brown 褐(棕色) (1)	
E 25-22	NE 25-22	22.0	33.5						Black 黑色 (2)	
E 35-16	NE 35-16	16.0	30.0	13.0	8.7	8.3	#2	35.0	Dust-colour 灰褐色 (1)	
E 35-25	NE 35-25	25.0	39.0						Red 红色 (2)	
E 50-20	NE 50-20	20.0	35.5	15.8	10.9	10.3	#1	50.0	Olives color 橄榄色 (1)	
E 50-25	NE 50-25	25.0	40.5						Blue 蓝色 (2)	
E 70-20	NE 70-20	20.0	37.0	16.0	14.3	13.5	2/*0	70	Yellow 黄	
E 70-25	NE 70-25	25.0	42.0							
E 70-27	NE 70-27	27.0	44.0							
E 95-25	NE 95-25	25.0	43.6	18.2	15.3	14.5	3/0	95	Red 红	
E 120-27	NE 120-27	27.0	47.6	20.3	17.5	16.5	4/4	120	Blue 蓝	
E 120-32	NE 120-32	32.0	52.6							
E 150-25	NE 150-25	25.0	49.6	23.4	20.6	19.6	250/300	150	Yellow 黄	
E150-27	NE150-27	27.0	51.6							
E 150-32	NE 150-32	32.0	56.6							

NON-INSULATED CORD END TERMINAL(TG) 管形裸端头



型号 ITEM NO.	尺寸 Dimension(mm)				导体截面积 Conductor section (mm ²)	
	L1	DΦ	CΦ	W	A.W.G	mm ²
EN 0506	6.0	1.3	1.0	1.7	#22	0.5
EN 0508	8.0					
EN 0510	10.0					
EN 0512	12.0					
EN 7506	6.0	1.5	1.2	1.9	#20	0.75
EN 7508	8.0					
EN 7510	10.0					
EN 7512	12.0					
EN 1006	6.0	1.8	1.4	2.2	#18	1.0
EN 1008	8.0					
EN 1010	10.0					
EN 1012	12.0					
EN 1507	7.0	2.0	1.7	2.5	#16	1.5
EN 1508	8.0					
EN 1510	10.0					
EN 1512	12.0					
EN 1518	18.0	2.6	2.2	3.3	#14	2.5
EN 2507	7.0					
EN 2508	8.0					
EN 2510	10.0					
EN 2512	12.0	3.2	2.8	3.9	#12	4.0
EN 2518	18.0					
EN 4009	9.0					
EN 4012	12.0					
EN 4018	18.0	3.9	3.5	4.8	#10	6.0
EN 6010	10.0					
EN 6012	12.0					
EN 6015	15.0					
EN 6018	18.0	4.9	4.5	5.8	#7	10.0
EN 10-12	12.0					
EN 10-15	15.0					
EN 10-18	18.0					
EN 16-12	12.0	6.2	5.8	7.2	#5	16.0
EN 16-15	15.0					
EN 16-18	18.0					
EN 25-16	16.0					
EN 25-22	22.0	7.9	7.5	9.1	#4	25.0
EN 35-16	16.0					
EN 35-25	25.0					
EN 50-20	20.0					
EN 50-25	25.0	10.9	10.3	12.4	#1	50.0

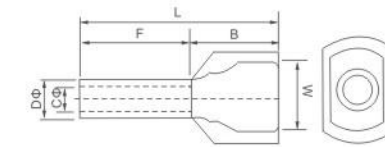

INSULATED TWIN CORD END TERMINAL 双线管形预绝缘端头

型号 ITEM NO.	截面积 Conductor (mm ²)	尺寸 Dimension(mm)						颜色 Color	
		L1	DΦ	CΦ	W	A.W.G	mm ²	German	French
TE 0508	2x0.5	8.0	14.0	5.0	6.0	1.8	1.5	白 White	白 White
TE 7508	2x0.75	8.0	14.5	5.5	6.5	2.1	1.8	蓝 Blue	灰 Gray
TE 7510	2x0.75	10.0	16.5	5.5	6.5	2.1	1.8		
TE 1008	2x1.0	8.0	14.9	5.5	6.9	2.3	2.0	红 Red	红 Red
TE 1010	2x1.0	10.0	16.9	5.5	6.9	2.3	2.0		
TE 1508	2x1.5	8.0	16.7	6.7	8.7	2.6	2.3	黑 Black	黄 Yellow
TE 1512	2x1.5	12.0	20.7	6.7	8.7	2.6	2.3		
TE 2510	2x2.5	10.0	19.8	8.0	9.8	3.3	2.9	灰 Gray	蓝 Blue
TE 2513	2x2.5	13.0	22.8	8.0	9.8	3.3	2.9		
TE 4012	2x4.0	12.0	21.2	8.8	9.2	4.2	3.8	橘 Orange	灰 Gray
TE 6014	2x6.0	14.0	23.5	9.5	9.5	5.3	4.9	绿 Green	黄 Yellow
TE 10-14	2x10.0	14.0	26.5	12.6	12.5	6.9	6.5	棕 Brown	红 Red
TE 16-14	2x16.0	14.0	30.0	19.0	16.0	8.7	8.3	象牙白 Ivory	蓝 Blue

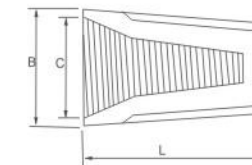

SCREW ON WIRE CONNECTOR 螺旋式压线帽

型号 ITEM NO.	铅组合范围 Lead combination range	尺寸 Dimension(mm)			颜色 Color		
		L	B	C	Gray	灰	
SP1	Min0.75x1+0.5x1	Max1.5x2	8.5	3.5	14.7	Gray	灰
SP2	Min0.75x3	Max1.5x3	10.1	6.5	17.5	Blue	蓝
SP3	Min0.75x3	Max1.5x3+1x1	11.2	8.0	21.4	Orange	橘
SP4	Min0.25x1+0.75x1	Max2.5x4+0.75x1	13.7	7.5	23.6	Yellow	黄
SP6	Min0.25x2	Max6x3+4x2	16.0	7.0	26.5	Red	红

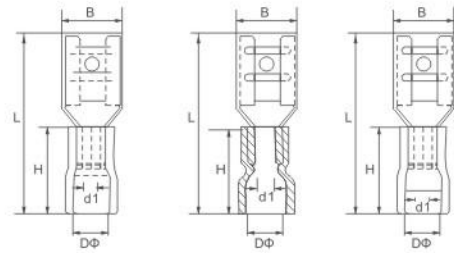

VINYL-INSULATED FEMALE DISCONNECTORS 母预绝缘端头

型号 ITEM NO.	接插规格 connecting spec. (mm)	材料厚度 Thickness of material	尺寸 Dimension(mm)					AWG	颜色 Color	说明 Explanation
			B	Dφ	dφ	L	H			
FDD1.25-110(5)	0.5x2.8	0.3	3.8	3.8	1.7	18.7	10.6	22-16	红 Red	材质: PVC和黄铜 镀层: 铜锡或亚锡 注: 尼龙 (NFDD), 尼龙加铜套 (NC-FDD) Material: PVC+Brass Plating: Tin Note: Nylon(NFDD), Nylon+Copper sleeve(NC-FDD)
FDD1.25-110(8)	0.8x2.8	0.3	3.8	3.8	1.7	18.7	10.6			
FDD1.25-187(5)	0.5x4.75	0.35	5.6	3.8	1.7	18.7	10.6			
FDD1.25-187(8)	0.8x4.75	0.35	5.6	3.8	1.7	18.7	10.6			
FDD1.25-205	0.5x5.2	0.35	6.5	3.8	1.7	20.0	10.6			
FDD1.25-250	0.8x6.35	0.4	7.4	3.8	1.7	21.0	10.6			
FDD 2-110(5)	0.5x2.8	0.3	3.8	4.3	2.3	18.7	10.6	16-14	蓝 Blue	
FDD 2-110(8)	0.8x2.8	0.3	3.8	4.3	2.3	18.7	10.6			
FDD 2-187(5)	0.5x4.75	0.35	5.6	4.3	2.3	18.7	10.6			
FDD 2-187(8)	0.8x4.75	0.35	5.6	4.3	2.3	18.7	10.6			
FDD 2-205	0.5x5.2	0.35	6.5	4.3	2.3	19.7	10.6			
FDD 2-250	0.8x6.35	0.4	7.4	4.3	2.3	21.4	10.6			
FDD 2-312	0.8x8.0	0.4	8.9	4.3	2.3	24.1	10.6	12-10	黄 Yellow	
FDD 5.5-250	0.8x6.35	0.4	7.4	5.7	3.4	24.5	13.0			
FDD 5.5-375	1.2x9.4	0.5	10.9	5.7	3.4	29.3	13.5			

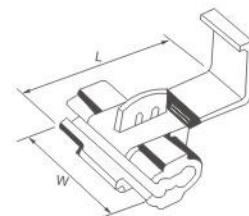

SPLICE CONNECTOR 快速连接接头

型号 ITEM NO.	尺寸 Dimension(mm)		A.W.G	颜色 Color
	W	L		
878100	20.0	27.0	22-18A.W.G 0.5-1.0mm ²	红 Red
878101	20.0	27.0	18-14A.W.G 0.75-2.5mm ²	蓝 Blue
878101	20.0	27.0	18-14A.W.G 0.75-2.5mm ²	白 White
878100	20.5	34.5	12-10A.W.G 4-6mm ²	黄 Yellow

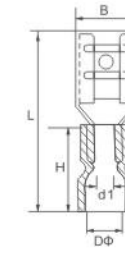

EFDD
(easy entry)

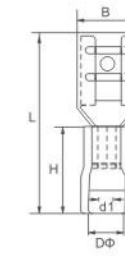

C-FDD
(copper sleeve)

VINYL-INSULATED FEMALE DISCONNECTORS 母预绝缘端头 EASY ENTRY AND COPPER SLEEVE (易进式和铜套)

型号 ITEM NO.	接插规格 connecting spec. (mm)	材料厚度 Thickness of material	尺寸 Dimension(mm)					AWG	颜色 Color	说明 Explanation	
			B	Dφ	dφ	L	H				
EFDD1.25-110(5)	C-FDD1.25-110(5)	0.5x2.8	0.3	3.8	3.8	1.7	18.7	10.6	22-16	红 Red	材质: PVC和黄铜 镀层: 铜锡或亚锡 注: 常规(FDD), 易进式(EFDD), 加铜套(C-FDD) Material: PVC+Brass Plating: Tin Note: Nylon(EFDD), PVC+Copper sleeve(C-FDD)
EFDD1.25-110(8)	C-FDD1.25-110(8)	0.8x2.8	0.3	3.8	3.8	1.7	18.7	10.6			
EFDD1.25-187(5)	C-FDD1.25-187(5)	0.5x4.75	0.35	5.6	3.8	1.7	18.7	10.6			
EFDD1.25-187(8)	C-FDD1.25-187(8)	0.8x4.75	0.35	5.6	3.8	1.7	18.7	10.6			
EFDD1.25-205	C-FDD1.25-205	0.5x5.2	0.35	6.5	3.8	1.7	20.0	10.6			
EFDD1.25-250	C-FDD1.25-250	0.8x6.35	0.4	7.4	3.8	1.7	21.0	10.6			
EFDD 2-110(5)	C-FDD 2-110(5)	0.5x2.8	0.3	3.8	4.3	2.3	18.7	10.6	16-14	蓝 Blue	
EFDD 2-110(8)	C-FDD 2-110(8)	0.8x2.8	0.3	3.8	4.3	2.3	18.7	10.6			
EFDD 2-187(5)	C-FDD 2-187(5)	0.5x4.75	0.35	5.6	4.3	2.3	18.7	10.6			
EFDD 2-187(8)	C-FDD 2-187(8)	0.8x4.75	0.35	5.6	4.3	2.3	18.7	10.6			
EFDD 2-205	C-FDD 2-205	0.5x5.2	0.35	6.5	4.3	2.3	19.7	10.6			
EFDD 2-250	C-FDD 2-250	0.8x6.35	0.4	7.4	4.3	2.3	21.4	10.6			
EFDD 2-312	C-FDD 2-312	0.8x8.0	0.4	8.9	4.3	2.3	24.1	10.6	12-10	黄 Yellow	
EFDD 5.5-250	C-FDD 5.5-250	0.8x6.35	0.4	7.4	5.7	3.4	24.5	13.0			
EFDD 5.5-375	C-FDD 5.5-375	1.2x9.4	0.5	10.9	5.7	3.4	29.3	13.5			



EMPD (easy entry)

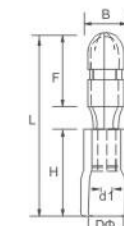

MPD

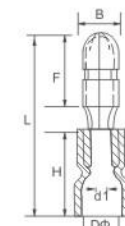

EMPD
(easy entry)

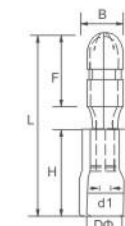

C-MPD
(copper sleeve)

VINYL-INSULATED BULLET DISCONNECTORS 子弹形公预绝缘接头 EASY ENTRY AND COPPER SLEEVE (易进式和铜套)

型号 ITEM NO.	材料厚度 Thickness of material	尺寸 Dimension(mm)					AWG	颜色 Color	说明 Explanation		
		bφ	F	Dφ	H	L					
MPD 1.25-156	EMPD 1.25-156	C-MPD 1.25-156	0.4	4.0	10.6	1.7	10.6	21.2	22-16	红 Red	材质: PVC和黄铜 厚度: 0.4mm 镀层: 铜锡或亚锡 注: 常规(MPD) 易进式 (EFDD), 加铜套(C-MPD) Material: PVC+Brass Plating: Tin Note: Normal(MPD), Easy entry(EMPD), Copper sleeve(C-MPD)
MPD 2-156	EMPD 2-156	C-MPD 2-156	0.4	4.0	10.6	2.3	12.6	21.2	16-14	蓝 Blue	
MPD 2-195	EMPD 2-195	C-MPD 2-195	0.4	5.0	10.6	2.3	10.0	21.2			
MPD 5.5-195	EMPD 5.5-195	C-MPD 5.5-195	0.4	5.0	12.0	3.4	13.5	25.5	12-10	黄 Yellow	

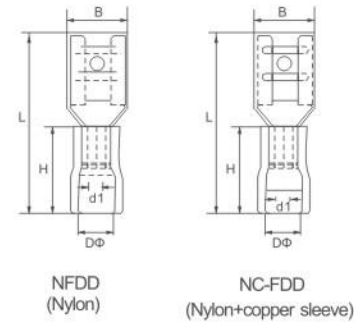

NYLON-INSULATED FEMALE DISCONNECTORS 尼龙母预绝缘端头 (加铜套)

型号 ITEM NO.		接插规格 connecting spec (mm)	材料厚度 Thickness of material	尺寸 Dimension(mm)					AWG	颜色 Color	说明 Explanation
B	Dφ	dφ	L	H							
NFDD1.25-110(5)	NC-FDD1.25-110(5)	0.5x2.8	0.3	3.8	3.8	1.7	18.7	10.6	16-14	红 Red	材质: 尼龙和黄铜 镀层: 铜锡或亚锡 注: 尼龙 (NFDD), 尼龙 加铜套 (NC-FDD)
NFDD1.25-110(8)	NC-FDD1.25-110(8)	0.8x2.8	0.3	3.8	3.8	1.7	18.7	10.6			
NFDD1.25-187(5)	NC-FDD1.25-187(5)	0.5x4.75	0.35	5.6	3.8	1.7	18.7	10.6			
NFDD1.25-187(8)	NC-FDD1.25-187(8)	0.8x4.75	0.35	5.6	3.8	1.7	18.7	10.6			
NFDD1.25-205	NC-FDD1.25-205	0.5x5.2	0.35	6.5	3.8	1.7	20.0	10.6			
NFDD1.25-250	NC-FDD1.25-250	0.8x6.35	0.4	7.4	3.8	1.7	21.0	10.6			
NFDD 2-110(5)	NC-FDD 2-110(5)	0.5x2.8	0.3	3.8	4.3	2.3	18.7	10.6			
NFDD 2-110(8)	NC-FDD 2-110(8)	0.8x2.8	0.3	3.8	4.3	2.3	18.7	10.6			
NFDD 2-187(5)	NC-FDD 2-187(5)	0.5x4.75	0.35	5.6	4.3	2.3	18.7	10.6	12-10	蓝 Blue	Material:Nylon+Brass Plating:Tin Note:Nylon(NFDD),Nylon+ Copper sleeve(NC-FDD)
NFDD 2-187(8)	NC-FDD 2-187(8)	0.8x4.75	0.35	5.6	4.3	2.3	18.7	10.6			
NFDD 2-205	NC-FDD 2-205	0.5x5.2	0.35	6.5	4.3	2.3	19.7	10.6			
NFDD 2-250	NC-FDD 2-250	0.8x6.35	0.4	7.4	4.3	2.3	21.4	10.6			
NFDD 2-312	NC-FDD 2-312	0.8x8.0	0.4	8.9	4.3	2.3	24.1	10.6	22-16	黄 Yellow	
NFDD 5.5-250	NC-FDD 5.5-250	0.8x6.35	0.4	7.4	5.7	3.4	24.5	13.0			
NFDD 5.5-375	NC-FDD 5.5-375	1.2x9.4	0.5	10.9	5.7	3.4	29.3	13.5			

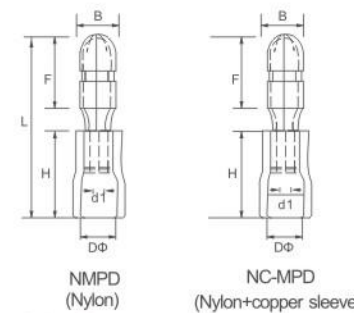

NYLON-INSULATED BULLET DISCONNECTORS 尼龙子弹形公预绝缘接头 (加铜套)

型号 ITEM NO.		材料厚度 Thickness of material	尺寸 Dimension(mm)					AWG	颜色 Color	说明 Explanation
bφ	F	Dφ	H	L						
NMPD 1.25-156	NC-MPD 1.25-156	0.4	4.0	10.6	1.7	10.6	21.2	22-16	红 Red	材质: PVC和黄铜 厚度: 0.4mm 镀层: 铜锡或亚锡
NMPD 2-156	NC-MPD 2-156	0.4	4.0	10.6	2.3	12.6	21.2			
NMPD 2-195	NC-MPD 2-195	0.4	5.0	10.6	2.3	10.0	21.2	16-14	蓝 Blue	注: 常规(MPD)易进式 (EFDD), 加铜套 (C-MPD)
NMPD 5.5-195	NC-MPD 5.5-195	0.4	5.0	12.0	3.4	13.5	25.5			
NMPD 5.5-195	NC-MPD 5.5-195	0.4	5.0	12.0	3.4	13.5	25.5	12-10	黄 Yellow	Note: Normal(MPD),Easy entry(EMPD), Copper sleeve(C-MPD)

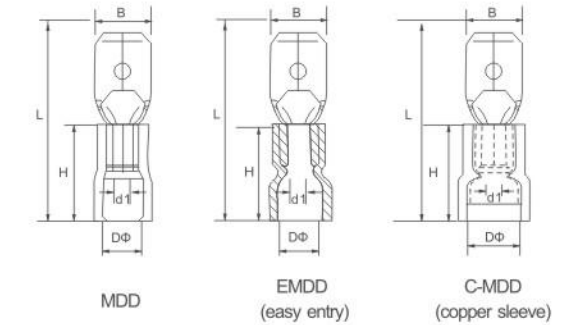

**VINYL-INSULATED MALE DISCONNECTORS 公预绝缘端头
EASY ENTRY AND COPPER SLEEVE (易进式和铜套)**

型号 ITEM NO.		Nema Tab (mm)	材料厚度 Thickness of material	尺寸 Dimension(mm)					AWG	颜色 Color	说明 Explanation	
B	Dφ	dφ	L	H								
MDD1.25-110(5)	EMDD1.25-110(5)	C-MDD1.25-110(5)	0.5x2.8	0.5	2.8	4.3	1.7	17.7	10.6	22-16	红 Red	材质: PVC和黄铜 镀层: 铜锡或亚锡 注: 常规(MDD),易进式 (EMDD),加铜套 (C-MDD)
MDD1.25-110(8)	EMDD1.25-110(8)	C-MDD1.25-110(8)	0.8x2.8	0.8	2.8	4.3	1.7	17.7	10.6			
MDD1.25-187(5)	EMDD1.25-187(5)	C-MDD1.25-187(5)	0.5x4.75	0.5	4.75	4.3	1.7	20.0	10.6			
MDD1.25-187(8)	EMDD1.25-187(8)	C-MDD1.25-187(8)	0.8x4.75	0.8	4.75	4.3	1.7	20.0	10.6			
MDD1.25-250	EMDD1.25-250	C-MDD1.25-250	0.8x6.35	0.4x2	6.35	4.3	1.7	21.6	10.6			
MDD 2-187(5)	EMDD 2-187(5)	C-MDD 2-187(5)	0.5x4.75	0.5	4.75	4.3	2.3	20.0	20.0			
MDD 2-187(8)	EMDD 2-187(8)	C-MDD 2-187(8)	0.8x4.75	0.8	4.75	4.3	2.3	20.0	20.0			
MDD 2-250	EMDD 2-250	C-MDD 2-250	0.8x6.35	0.4x2	6.35	4.3	2.3	21.6	21.6			
MDD 5.5-250	EMDD 5.5-250	C-MDD 5.5-250	0.8x6.35	0.4x2	6.35	5.7	3.4	25.5	13.5	12-10	黄 Yellow	Material:PVC+Brass Plating:Tin Note:Normal(MDD),Easy entry(EMDD),Copper sleeve(C-MDD)

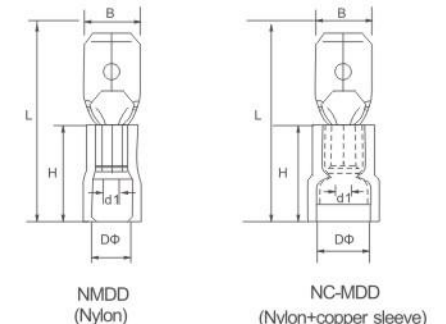

NYLON-INSULATED MALE DISCONNECTORS 尼龙公预绝缘端头 (加铜套)

型号 ITEM NO.		Nema Tab (mm)	材料厚度 Thickness of material	尺寸 Dimension(mm)					AWG	颜色 Color	说明 Explanation
B	Dφ	dφ	L	H							
NMDD1.25-110(5)	NC-MDD1.25-110(5)	0.5x2.8	0.5	2.8	4.3	1.7	17.7	10.6	22-16	红 Red	材质: PVC和黄铜 厚度: 0.4mm 镀层: 铜锡或亚锡 注: 尼龙(NMDD),尼龙加铜套(NCMDD)
NMDD1.25-110(8)	NC-MDD1.25-110(8)	0.8x2.8	0.8	2.8	4.3	1.7	17.7	10.6			
NMDD1.25-187(5)	NC-MDD1.25-187(5)	0.5x4.75	0.5	4.75	4.3	1.7	20.0	10.6			
NMDD1.25-187(8)	NC-MDD1.25-187(8)	0.8x4.75	0.8	4.75	4.3	1.7	20.0	10.6			
NMDD1.25-250	NC-MDD1.25-250	0.8x6.35	0.4x2	6.35	4.3	1.7	21.6	10.6	16-14	蓝 Blue	Material: PVC+Brass Plating: Tin Note: Nylon(NMDD),Nylon+Copper sleeve (NC-MDD)
NMDD 2-187(5)	NC-MDD 2-187(5)	0.5x4.75	0.5	4.75	4.3	2.3	20.0	10.6			
NMDD 2-187(8)	NC-MDD 2-187(8)	0.8x4.75	0.8	4.75	4.3	2.3	20.0	10.6			
NMDD 2-250	NC-MDD 2-250	0.8x6.35	0.4x2	6.35	4.3	2.3	21.6	10.6	12-10	黄 Yellow	
NMDD 5.5-250	NC-MDD 5.5-250	0.8x6.35	0.4x2	6.35	5.7	3.4	25.5	13.5			

VINYL FULLY INSULATED FEMALE DISCONNECTORS

母全绝缘接头



型号 ITEM NO.	Nema Tab (mm)	尺寸 Dimension(mm)				AWG	说明 Explanation
		B	DΦ	dΦ	L		
FDFD1.25-187(5)	0.5x4.75	5.6	3.8	1.7	20.8	22-16 导线截面: 0.5-1.5mm ² 最大电流: 19A 材质: 紫铜 镀层: 锡 Cable size: 0.5-1.5mm ² Max current: I _{max} =27A Material: Copper Plating: Tin	
FDFD1.25-187(8)	0.8x4.75	5.6	3.8	1.7	20.8		
FDFD1.25-250	0.8x6.35	7.4	3.8	1.7	24.3		
FDFD 2-187(5)	0.5x4.75	5.6	4.3	2.3	20.8		
FDFD 2-187(8)	0.8x4.75	5.6	4.3	2.3	20.8		
FDFD 2-250	0.8x6.35	7.4	4.3	2.3	24.3		
FDFD 5.5-250	0.8x6.35	7.4	5.7	3.4	24.3		



VINYL FULLY INSULATED RECEPTACLE DISCONNECTORS

子弹形母预绝缘接头

型号 ITEM NO.	材料厚度 Thickness of material	尺寸 Dimension(mm)					颜色 Color	AWG	说明 Explanation
		bΦ	BΦ	DΦ	F	L			
FRD 1.25-156	0.4	4.0	6.3	1.7	13.0	24.5	红 Red	22-16 导线截面: 0.5-1.5mm ² 最大电流: 19A 材质: 紫铜 镀层: 锡 Cable size: 0.5-1.5mm ² Max current: I _{max} =27A Material: Copper Plating: Tin	
FRD 2-156	0.4	4.0	6.3	2.3	14.0	24.5	蓝 Blue		
FRD 2-195	0.4	5.0	7.0	2.3	14.0	25.5			
FRD 5.5-195	0.4	5.0	7.0	3.4	14.0	24.5	黄 Yellow		

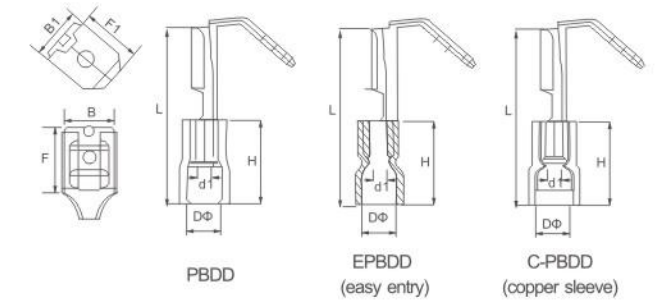

VINYL-INSULATED PIGGY-BACK DISCONNECTORS 肩背形公母预绝缘端头

型号 ITEM NO.			Nema Tab (mm)	尺寸 Dimension(mm)						说明 Explanation
PBDD	EPBDD	C-PBDD		B	B1	H	DΦ	dΦ	L	
PBDD 1.25-250	EPBDD 1.25-250	C-PBDD 1.25-250	0.8x6.35	7.4	6.3	10.6	3.8	1.7	21.0	材质: PVC和黄铜 厚度: 0.4mm 镀层: 铜锡或亚锡 注: 常规(PBDD),易进式(EPBDD),加铜套(C-PBDD) Material: PVC+Brass Plating: Tin Note: Normal(PBDD),Easy entry(EPBDD),Copper sleeve(C-PBDD)
PBDD 2-250	EPBDD 2-250	C-PBDD 2-250	0.86.35	7.7	6.3	10.6	4.3	2.3	21.0	
PBDD 5.5-250	EPBDD 5.5-250	C-PBDD 5.5-250	0.8x6.35	7.7	6.3	13.5	5.7	3.4	23.5	

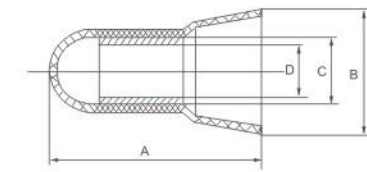

Shell material: Nylon 66,94V-2,certificated agree by UL. Usage:Peel the coat of wire,then insert to tube,use pincers to fix them. Feature:Nylon shell,long copper tube,easy to conduct electricity and hold wire tightly.

CLOSE-END WIRE CONNECTOR 白色压线帽

型号 ITEM NO.	Nema Tab (mm)	W (mm)		D (mm)	合适的线 Suitable Wires		包装 Packing	说明 Explanation
		B	C		mm ²	AWG		
DL-Φ3	17.8	7.2	3.6	2.5	1.25	22-16	100PCS& 1000PCS	导线截面: 0.5-1.5mm ² (美国线规22~16) 最大电流: 19A 材质: 紫铜 镀层: 锡 Cable size: 0.5-1.5mm ² (A.W.G22~16)
DL-Φ4	21.0	8.2	4.0	2.9	2.0	16-14		
DL-Φ5	22.5	9.0	4.8	3.9	5.5	12-10		
DL-Φ6	25.0	10.0	5.6	4.5	8.0	8	100PCS& 500PCS	Max current: I _{max} =27A Material: Copper Plating: Tin
DL-Φ7	24.2	11.0	6.5	5.4	10	8-6		
DL-Φ8	25.6	11.8	7.5	6.0	13	6	100PCS	
DL-Φ10	29.5	13.5	9.3	7.5	16	4		



EDBV (easy entry)

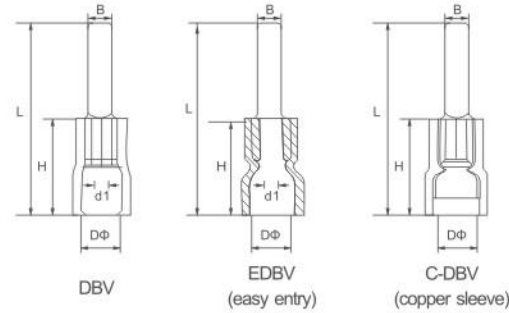

VINYL-INSULATED BLADE TERMINAL 片形预绝缘端头

EASY ENTRY AND COPPER SLEEVE (易进式和铜套)

型号 ITEM NO.			尺寸 Dimension(mm)					AWG	T	颜色 Color	说明 Explanation
B	L	F	H	DΦ	d1						
DBV 1.25-10	EDBV 1.25-10	C-DBV 1.25-10	2.3	20.6	10.0	10.6	4.3	22-16	0.7	红 Red	材质: PVC和紫铜 镀层: 铜锡或亚锡 注: 常规(DBV), 易进式(EDBV), 加铜套(C-DBV)
DBV 1.25-11	EDBV 1.25-11	C-DBV 1.25-11	2.3	21.6	11.0						
DBV 1.25-14	EDBV 1.25-14	C-DBV 1.25-14	2.3	24.6	14.0						
DBV 1.25-18	EDBV 1.25-18	C-DBV 1.25-18	2.3	28.6	18.0						
DBV 2-10	EDBV 2-10	C-DBV 2-10	2.55	20.5	9.9	10.6	4.9	16-14	0.8	蓝 Blue	Material:PVC+紫铜 Plating:Tin Note:Normal(DBV),Easy entry(EDBV),Copper sleeve(C-DBV)
DBV 2-14	EDBV 2-14	C-DBV 2-14	2.55	24.6	14.0						
DBV 2-18	EDBV 2-18	C-DBV 2-18	2.55	28.6	18.0						
DBV 5.5-10	EDBV 5.5-10	C-DBV 5.5-10	2.8	23.3	9.8	13.5	5.6	12-10	1.0	黄 Yellow	
DBV 5.5-14	EDBV 5.5-14	C-DBV 5.5-14	4.5	27.3	13.8						
DBV 5.5-18	EDBV 5.5-18	C-DBV 5.5-18	4.5	31.3	17.8						

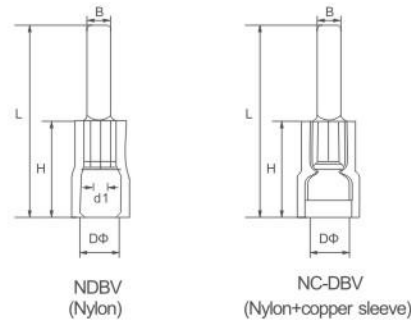

NYLON-INSULATED BLADE TERMINAL 尼龙片形预绝缘端头 (加铜套)

型号 ITEM NO.			尺寸 Dimension(mm)					AWG	T	颜色 Color	说明 Explanation
B	L	F	H	DΦ	d1						
NDBV 1.25-10	NC-DBV 1.25-10		2.3	20.6	10.0	10.6	4.3	22-16	0.7	红 Red	材质: 尼龙和紫铜 镀层: 铜锡或亚锡 注: 尼龙 (NDBV), 尼龙加铜套 (NC-DBV)
NDBV 1.25-11	NC-DBV 1.25-11		2.3	21.6	11.0						
NDBV 1.25-14	NC-DBV 1.25-14		2.3	24.6	14.0						
NDBV 1.25-18	NC-DBV 1.25-18		2.3	28.6	18.0						
NDBV 2-10	NC-DBV 2-10		2.55	20.5	9.9	10.6	4.9	16-14	0.8	蓝 Blue	Material: NYLON+COPPER Plating: Tin Note:Nylon(NDBV),Nylon+Copper sleeve(NC-DBV)
NDBV 2-14	NC-DBV 2-14		2.55	24.6	14.0						
NDBV 2-18	NC-DBV 2-18		2.55	28.6	18.0						
NDBV 5.5-10	NC-DBV 5.5-10		2.8	23.3	9.8	13.5	5.6	12-10	1.0	黄 Yellow	
NDBV 5.5-14	NC-DBV 5.5-14		4.5	27.3	13.8						
NDBV 5.5-18	NC-DBV 5.5-18		4.5	31.3	17.8						

NON-INSULATED BLADE TERMINAL

片形裸端头

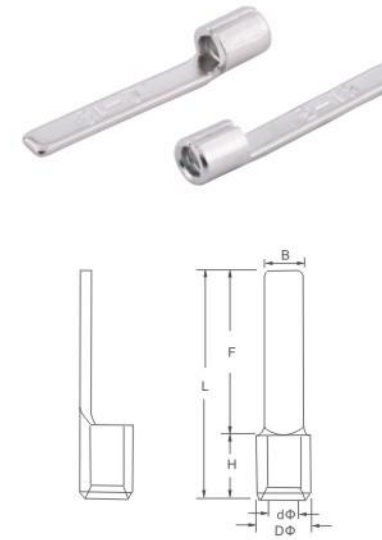

型号 ITEM NO.	尺寸 Dimension(mm)						说明 Explanation
	B	L	F	E	DΦ	dΦ	
DBN 1.25-10	2.4	14.8	10.0	4.8	3.4	1.7	导线截面: 0.5-1.5mm ² (美国线规22~16) 最大电流: 19A 材质: 紫铜 镀层: 锡 Cable size: 0.5-1.5mm ² (AW.G22~16) Max current: I _{max} =27A Material: Copper Plating:Tin
DBN 1.25-11	2.4	15.8	11.0				
DBN 1.25-14	2.4	18.8	14.0				
DBN 1.25-18	2.4	22.8	18.0	4.8	4.1	2.3	
DBN 2-9	2.5	14.6	9.9				
DBN 2-18	2.5	22.8	18.0	6.0	5.6	3.4	
DBN 5.5-10	2.8	14.8	10.0				
DBN 5.5-14	4.5	21.0	14.0	8.5	7.2	4.5	
DBN 5.5-18	4.5	23.0	18.0				
DBN 8-14	5.0	22.5	14.0	14.0	9.0	6.5	
DBN 14-16	6.0	30.6	16.0				

NON-INSULATED PIN TERMINAL

针形裸端头



型号 ITEM NO.	尺寸 Dimension(mm)					说明 Explanation
	F	L	E	DΦ	dΦ	
PTN 1.25-9	1.9	13.8	4.8	3.4	1.7	导线截面: 0.5-1.5mm ² (美国线规22~16) 最大电流: 19A 材质: 紫铜 镀层: 锡 Cable size: 0.5-1.5mm ² (AW.G22~16) Max current: I _{max} =27A Material: Copper Plating:Tin
PTN 1.25-10	1.9	14.8				
PTN 1.25-12	1.9	16.8				
PTN 1.25-13	1.9	17.8				
PTN 1.25-18	1.9	22.8	4.8	4.1	2.3	
PTN 2-9	1.9	13.8				
PTN 2-10	1.9	14.8	6.0	5.0	3.0	
PTN 2-12	1.9	16.8				
PTN 2-13	1.9	17.8	8.5	7.2	4.5	
PTN 2-18	1.9	22.8				
PTN 3.5-10	2.8	14.8	14.0	9.0	6.5	
PTN 3.5-13	2.8	19.8				
PTN 5.5-13	2.8	19.8	6.0	5.6	3.4	

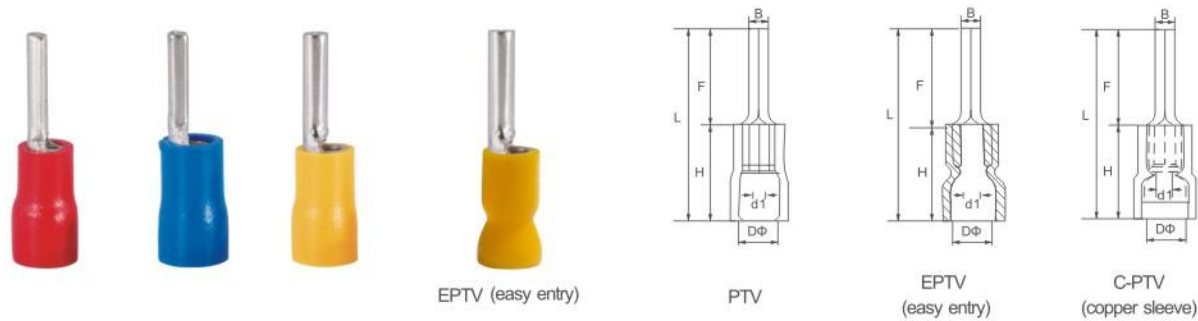

VINYL-INSULATED PIN TERMINAL 针形预绝缘端头
EASY ENTRY AND COPPER SLEEVE (易进式和铜套)

型号 ITEM NO.			尺寸 Dimension(mm)				AWG	颜色 Color	说明 Explanation
F	L	H	DΦ						
PTV1.25-9	EPTV1.25-9	C-PTV1.25-9	1.9	19.0	10.6	4.3	22-16	红 Red	材质: PVC和紫铜 镀层: 铜锡或亚锡 注: 常规(PTV),易进式(EPTV),加铜套(C-PTV) Material: PVC+COPPER Plating: Tin Note: Normal(PTV),Easy entry(EPTV),Copper sleeve(C-PTV)
PTV1.25-10	EPTV1.25-10	C-PTV1.25-10	1.9	20.6					
PTV1.25-12	EPTV1.25-12	C-PTV1.25-12	1.9	22.6					
PTV1.25-13	EPTV1.25-13	C-PTV1.25-13	1.9	23.6					
PTV1.25-18	EPTV1.25-18	C-PTV1.25-18	1.9	28.6					
PTV 2-9	EPTV 2-9	C-PTV 2-9	1.9	19.0					
PTV 2-10	EPTV 2-10	C-PTV 2-10	1.9	20.6	10.6	4.9	16-14	蓝 Blue	
PTV 2-12	EPTV 2-12	C-PTV 2-12	1.9	22.0					
PTV 2-13	EPTV 2-13	C-PTV 2-13	1.9	23.6					
PTV 2-18	EPTV 2-18	C-PTV 2-18	1.9	28.6	13.0	6.2	12-10	黑 Black	
PTV 3.5-10	EPTV 3.5-10	C-PTV 3.5-10	2.8	20.0					
PTV 3.5-12	EPTV 3.5-12	C-PTV 3.5-12	2.8	25.5					
PTV 5.5-13	EPTV 5.5-13	C-PTV 5.5-13	2.8	26.0	13.5	6.7	12-10	黄 Yellow	

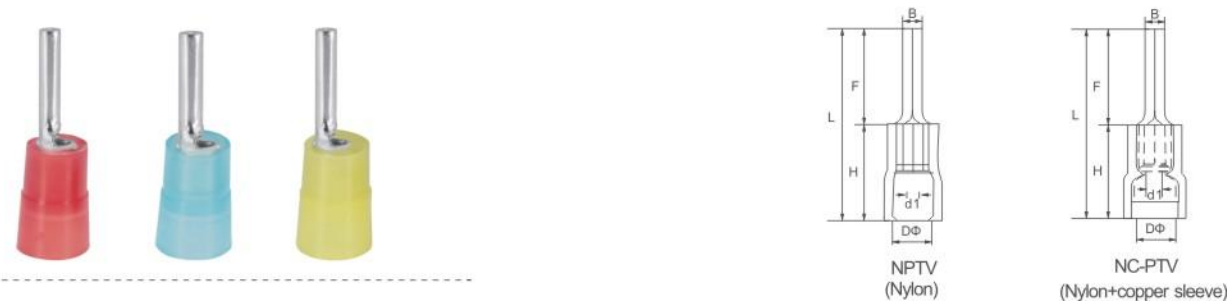

NYLON-INSULATED PIN TERMINAL 尼龙针形预绝缘端头 (加铜套)

型号 ITEM NO.			尺寸 Dimension(mm)				AWG	颜色 Color	说明 Explanation
F	L	H	DΦ						
NPTV1.25-9	NC-PTV1.25-9	1.9	19.0	10.6	4.3	22-16	红 Red	材质: PVC和紫铜 镀层: 铜锡或亚锡 注: 尼龙(NPTV),尼龙加铜套(NC-PTV) Material: PVC+COPPER Plating: Tin Note: Nylon(NPTV),Nylon+Copper sleeve(NC-PTV)	
NPTV1.25-10	NC-PTV1.25-10	1.9	20.6						
NPTV1.25-12	NC-PTV1.25-12	1.9	22.6						
NPTV1.25-13	NC-PTV1.25-13	1.9	23.6						
NPTV1.25-18	NC-PTV1.25-18	1.9	28.6						
NPTV 2-9	NC-PTV 2-9	1.9	19.0						
NPTV 2-10	NC-PTV 2-10	1.9	20.6	10.6	4.9	16-14	蓝 Blue		
NPTV 2-12	NC-PTV 2-12	1.9	22.0						
NPTV 2-13	NC-PTV 2-13	1.9	23.6						
NPTV 2-18	NC-PTV 2-18	1.9	28.6	13.5	6.7	12-10	黄 Yellow		
NPTV 5.5-13	NC-PTV 5.5-13	2.8	26.0						

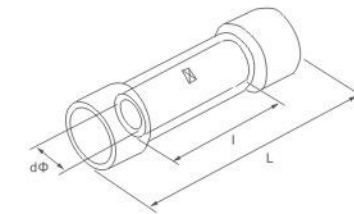

VINYL-INSULATED BUTT SPlice TERMINAL(TL-JTK) 长形全绝缘中间接头

型号 ITEM NO.	导线截面 Conductor section		尺寸 Dimension(mm)			最大值 I _{max}	颜色 Color	说明 Explanation
	A.W.G	mm ²	l	dΦ	L			
BV 1.25	22-16	0.5-1.5	15.0	1.7	25.0	19A	Red 红	导线截面: 0.5-1.5mm ² (美国线规22~16) 最大电流: 19A 材质: 紫铜 镀层: 锡 Cable size: 0.5-1.5mm ² (A.W.G22~16) Max current I _{max} =27A Material: Copper Plating: Tin
BV 2	16-14	1.5-2.5	15.0	2.3	25.0	27A	Blue 蓝	
BV 5.5	12-10	4-6	15.0	3.4	25.0	48A	Yellow 黄	
BV 8	#8	6-10	21.0	4.5	32.0	62A	Red 红	
BV 14	#6	10-16	26.0	5.8	42.0	88A	Blue 蓝	
BV 22	#4	16-25	29.0	7.7	50.0	115A	Yellow 黄	
BV 38	#2	35-50	32.0	9.4	55.0	160A	Red 红	
PVT 1.25	22-16	0.5-1.5	8.0	1.7	16.0	19A	Red 红	
PVT 2	16-14	1.5-2.5	8.0	2.3	16.0	27A	Blue 蓝	
PVT 5.5	12-10	4-6	8.0	3.4	20.5	48A	Yellow 黄	

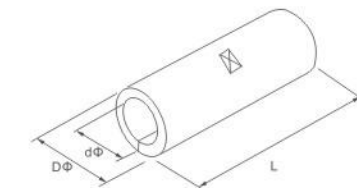

NON-INSULATED BUTT SPlice TERMINAL 中间裸端头

型号 ITEM NO.	导线截面 Conductor section		尺寸 Dimension(mm)			说明 Explanation
	A.W.G	mm ²	DΦ	dΦ	L	
BN 1.25	22-16	0.5-1.5	3.3	1.7	15.0	导线截面: 0.5-1.5mm ² (美国线规22~16) 最大电流: 19A 材质: 紫铜 镀层: 锡 Cable size: 0.5-1.5mm ² (A.W.G22~16) Max current I _{max} =27A Material: Copper Plating: Tin
BN 2	16-14	1.5-2.5	4.0	2.3	15.0	
BN 3.5	14-12	2.5-4	5.0	3.0	15.0	
BN 5.5	12-10	4-6	5.5	3.4	15.0	
BN 8	#8	10	7.1	4.5	21.0	
BN 14	#6	16	9.0	5.8	26.0	
BN 22	#4	25	11.4	7.7	29.0	
BN 38	#2	35	13.3	9.4	32.0	
BN 60	1/0	50	15.4	11.4	36.0	
BN 70	2/0	70	17.5	13.3	37.0	
BN 80	3/0	95	19.4	14.5	38.0	
BN 100	4/0	120	22.0	16.4	38.0	
BN 150	250-300MCM	150	26.5	19.5	54.0	
BN 180	300-350MCM	185	28.5	21.0	57.0	
BN 200	400MCM	240	32.5	24.0	63.0	
BN 325	500-600MCM	300	37.0	28.0	72.0	

LOCKING SPADE VINYL-INSULATED TERMINAL

锁扣叉形预绝缘端头

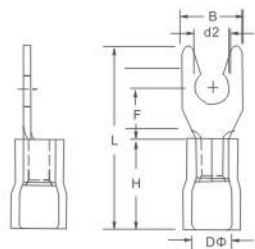

型号 ITEM NO.	美制螺栓号 USA SCREW	d2Φ (mm)	尺寸 Dimension(mm)					颜色 Color	说明 Explanation
			B	L	F	H	DΦ		
LSV 1.25-3.5	#6	3.7	6.4	21.2	6.5	10.0	4.3	红 Red	导线截面: 0.5-1.5mm ² (美国线规22~16) 最大电流: 19A 材质: 紫铜 镀层: 锡 Cable size: 0.5-1.5mm ² (A.W.G22~16) Max current: I _{max} =27A Material: Copper Plating: Tin
LSVS 1.25-4	#8	4.3	7.2	21.2	6.5				
LSVL 1.25-4	#8	4.3	8.1	21.2	6.5				
LSVS 1.25-5	#10	5.3	8.1	21.2	6.5				
LSVL 1.25-5	#10	5.3	9.5	21.2	6.5				
LSV 2-3.5	#6	3.7	6.0	21.2	6.5	10.0	4.9	蓝 Blue	导线截面: 0.5-1.5mm ² (美国线规22~16) 最大电流: 19A 材质: 紫铜 镀层: 锡 Cable size: 0.5-1.5mm ² (A.W.G22~16) Max current: I _{max} =27A Material: Copper Plating: Tin
LSVS 2-4	#8	4.3	7.2	21.2	6.5				
LSVL 2-4	#8	4.3	8.1	21.2	6.5				
LSVS 2-5	#10	5.3	8.1	21.2	6.5				
LSVL 2-5	#10	5.3	9.5	21.2	6.5				
LSV 5.5-3.5	#6	3.7	8.3	25.2	7.5	13.0	6.7	黄 Yellow	导线截面: 0.5-1.5mm ² (美国线规22~16) 最大电流: 19A 材质: 紫铜 镀层: 锡 Cable size: 0.5-1.5mm ² (A.W.G22~16) Max current: I _{max} =27A Material: Copper Plating: Tin
LSV 5.5-4	#8	4.3	8.3	25.2	7.5				
LSV 5.5-4	#10	5.3	9.0	23.9	7.5				
LSV 5.5-5	1/4	6.4	12.0	31.2	12.0				

LOCKING SPADE NON-INSULATED TERMINAL

锁扣叉形裸端头

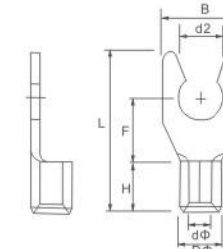

型号 ITEM NO.	d2Φ (mm)	尺寸 Dimension(mm)						A.W.G mm ²	说明 Explanation
		B	F	L	E	DΦ	dΦ		
LSNB1.25-3.5	3.7	6.4	6.5	16.0	4.8	3.4	1.7	22-16A.W.G. 0.5-1.5mm ²	导线截面: 0.5-1.5mm ² (美国线规22~16) 最大电流: 19A 材质: 紫铜 镀层: 锡 Cable size: 0.5-1.5mm ² (A.W.G22~16) Max current: I _{max} =27A Material: Copper Plating: Tin
LSNBS1.25-4	4.3	7.2							
LSNBL1.25-4	4.3	8.1							
LSNBS1.25-5	5.3	8.1							
LSNBL1.25-5	5.3	9.5							
LSNB 2-3.5	3.7	6.0	6.5	16.0	4.8	3.4	2.3	16-14A.W.G. 1.5-2.5mm ²	导线截面: 0.5-1.5mm ² (美国线规22~16) 最大电流: 19A 材质: 紫铜 镀层: 锡 Cable size: 0.5-1.5mm ² (A.W.G22~16) Max current: I _{max} =27A Material: Copper Plating: Tin
LSNBS 2-4	4.3	7.2							
LSNBL 2-4	4.3	8.1							
LSNBS 2-5	5.3	8.1							
LSNBL 2-5	5.3	9.5							
LSNB 5.5-3.5	3.7	8.3	7.5	19.5	6.0	5.6	3.4	12-10A.W.G. 4-6mm ²	导线截面: 0.5-1.5mm ² (美国线规22~16) 最大电流: 19A 材质: 紫铜 镀层: 锡 Cable size: 0.5-1.5mm ² (A.W.G22~16) Max current: I _{max} =27A Material: Copper Plating: Tin
LSNB 5.5-4	4.3	8.3							
LSNB 5.5-5	5.3	9.0							
LSNB 5.5-6	6.4	12.0							

HOOK RING VINYL-INSULATED TERMINAL

钩形预绝缘端头

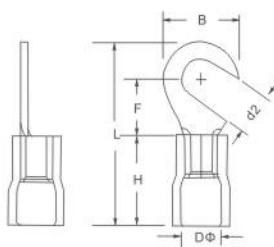

型号 ITEM NO.	美制螺栓号 USA SCREW	d2Φ (mm)	尺寸 Dimension(mm)					颜色 Color	说明 Explanation
			B	L	F	H	DΦ		
HV1.25-3.5	#6	3.7	8.0	21.0	7.0	10.0	4.3	红 Red	导线截面: 0.5-1.5mm ² (美国线规22~16) 最大电流: 19A 材质: 紫铜 镀层: 锡 Cable size: 0.5-1.5mm ² (A.W.G22~16) Max current: I _{max} =27A Material: Copper Plating: Tin
HV1.25-4	#8	4.3	8.0	21.0	7.0				
HV1.25-5	#10	5.3	8.0	21.0	7.0				
HV1.25-6	1/4	6.4	11.6	27.0	11.1				
HV2-3.5	#6	3.7	8.5	22.0	7.75	10.0	4.9	蓝 Blue	导线截面: 0.5-1.5mm ² (美国线规22~16) 最大电流: 19A 材质: 紫铜 镀层: 锡 Cable size: 0.5-1.5mm ² (A.W.G22~16) Max current: I _{max} =27A Material: Copper Plating: Tin
HV2-4	#8	4.3	8.5	22.0	7.75				
HV2-5	#10	5.3	9.5	22.0	7.25				
HV2-6	1/4	6.4	12.0	27.0	11.0				
HV5.5-3.5	#6	3.7	7.2	21.4	5.9	13.0	6.7	黄 Yellow	导线截面: 0.5-1.5mm ² (美国线规22~16) 最大电流: 19A 材质: 紫铜 镀层: 锡 Cable size: 0.5-1.5mm ² (A.W.G22~16) Max current: I _{max} =27A Material: Copper Plating: Tin
HV5.5-4	#8	4.3	9.5	25.5	8.25				
HV5.5-5	#10	5.3	9.5	25.5	8.25				
HV5.5-6	1/4	6.4	12.0	31.5	13.0				

HOOK RING NON-INSULATED TERMINAL

钩形裸端头

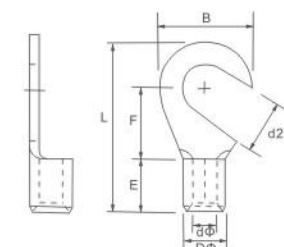

型号 ITEM NO.	d2Φ (mm)	尺寸 Dimension(mm)						A.W.G mm ²	说明 Explanation		
		B	F	L	E	DΦ	dΦ				
HNB1.25-3.5	3.7	8.0	7.0	15.8	4.8	3.4	1.7	12-16A.W.G. 0.5-1.5mm ²	导线截面: 0.5-1.5mm ² (美国线规22~16) 最大电流: 19A 材质: 紫铜 镀层: 锡 Cable size: 0.5-1.5mm ² (A.W.G22~16) Max current: I _{max} =27A Material: Copper Plating: Tin		
HNB1.25-4	4.3										
HNB1.25-5	5.3										
HNB1.25-6	6.4									11.6	11.0
HNB2.5-3.5	3.7	8.3	7.8	16.8	4.8	4.1	2.3	16-14A.W.G. 1.5-2.5mm ²	导线截面: 0.5-1.5mm ² (美国线规22~16) 最大电流: 19A 材质: 紫铜 镀层: 锡 Cable size: 0.5-1.5mm ² (A.W.G22~16) Max current: I _{max} =27A Material: Copper Plating: Tin		
HNB2.5-4	4.3										
HNB2.5-5	5.3									9.5	7.3
HNB2.5-6	6.4									12.0	11.0
HNB5.5-3.5	3.7	9.5	9.5	19.8	6.0	5.6	3.4	12-10A.W.G. 4-6mm ²	导线截面: 0.5-1.5mm ² (美国线规22~16) 最大电流: 19A 材质: 紫铜 镀层: 锡 Cable size: 0.5-1.5mm ² (A.W.G22~16) Max current: I _{max} =27A Material: Copper Plating: Tin		
HNB5.5-4	4.3										
HNB5.5-5	5.3										
HNB5.5-6	6.4									12.0	10.3
HNB5.5-8	8.4	15.0	13.5	27.0	8.5	7.2	4.5	8A.W.G. 8mm ²	Max current: I _{max} =27A Material: Copper Plating: Tin		
HNB 8-8	8.4	15.0	13.8	29.5							

FLANGE SPADE VINYL-INSULATED TERMINAL

凸缘叉形预绝缘端头

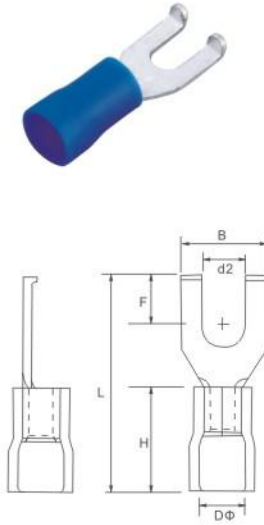

型号 ITEM NO.	美制螺栓号 USA SCREW	d2Φ (mm)	尺寸 Dimension(mm)					颜色 Color	说明 Explanation
			B	L	F	H	DΦ		
FSV 1.25-3.5	#6	3.7	7.5	19.0	5.1	10.0	4.3	红 Red	导线截面: 0.5-1.5mm ² (美国线规22~16) 最大电流: 19A 材质: 紫铜 镀层: 锡 Cable size: 0.5-1.5mm ² (A.W.G22~16) Max current: I _{max} =27A Material: Copper Plating:Tin
FSV 1.25-4	#8	4.3	7.5	19.0	5.1				
FSV 1.25-5	#10	5.3	7.5	19.0	5.1				
FSV 2-3.5	#6	3.7	7.5	19.0	5.2	10.0	4.9	蓝 Blue	导线截面: 0.5-1.5mm ² (美国线规22~16) 最大电流: 19A 材质: 紫铜 镀层: 锡 Cable size: 0.5-1.5mm ² (A.W.G22~16) Max current: I _{max} =27A Material: Copper Plating:Tin
FSV 2-4	#8	4.3	7.5	19.0	5.2				
FSV 2-5	#10	5.3	7.5	19.0	5.2				
FSV 5.5-3.5	#6	3.7	8.5	25.5	7.5	13.0	6.7	黄 Yellow	导线截面: 0.5-1.5mm ² (美国线规22~16) 最大电流: 19A 材质: 紫铜 镀层: 锡 Cable size: 0.5-1.5mm ² (A.W.G22~16) Max current: I _{max} =27A Material: Copper Plating: Tin
FSV 5.5-4	#8	4.3	8.5	25.5	7.5				
FSV 5.5-5	#10	5.3	8.5	25.5	7.5				

LIPPED BLADE VINYL-INSULATED TERMINAL

凹片形预绝缘端头

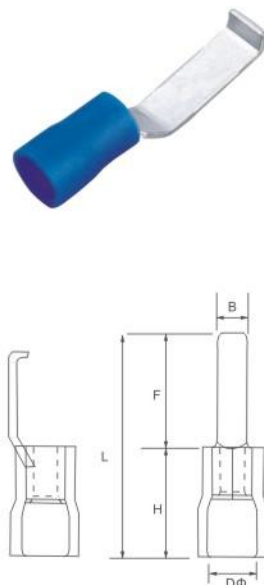

型号 ITEM NO.	尺寸 Dimension(mm)					颜色 Color	说明 Explanation
	B	L	F	H	DΦ		
LBV 1.25-3	3.0	26.8	16.8	10.0	4.3	红 Red	导线截面: 0.5-1.5mm ² (美国线规22~16) 最大电流: 19A 材质: 紫铜 镀层: 锡 Cable size: 0.5-1.5mm ² (A.W.G22~16) Max current: I _{max} =27A Material:Copper Plating:Tin
LBV 1.25-4.6	4.6	26.8	16.8				
LBV 2-3	3.0	26.8	16.8	10.0	4.9	蓝 Blue	导线截面: 0.5-1.5mm ² (美国线规22~16) 最大电流: 19A 材质: 紫铜 镀层: 锡 Cable size: 0.5-1.5mm ² (A.W.G22~16) Max current: I _{max} =27A Material: Copper Plating:Tin
LBV 2-4.6	4.6	26.8	16.8				
LBV 5.5-3	3.0	29.3	16.8	13.0	6.7	黄 Yellow	导线截面: 0.5-1.5mm ² (美国线规22~16) 最大电流: 19A 材质: 紫铜 镀层: 锡 Cable size: 0.5-1.5mm ² (A.W.G22~16) Max current: I _{max} =27A Material: Copper Plating: Tin
LBV 5.5-4.6	4.6	29.3	16.8				

LONG FULL INSULATING MIDDLE JOINT (NYLON)

长形全绝缘中间接头 (尼龙)

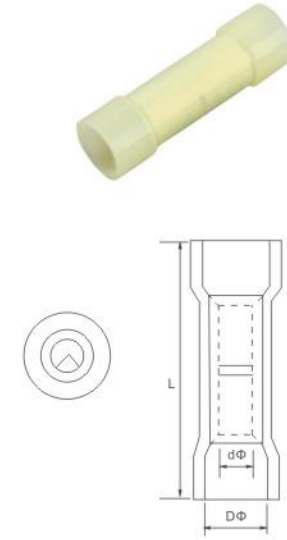

1_{max} = 26-22 A.W.G:9A 26-16 A.W.G:19A
16-14 A.W.G:27A 12-10 A.W.G:48A

Max withstanding pressure:105°C600V Insulating Cover Material:Nylon

型号 ITEM NO.	尺寸 Dimension(mm)			共同材料 Joint material	A.W.G (mm)	颜色 Color	说明 Explanation
	L	DΦ	dΦ				
BNY1.25	27.3	3.2	1.7	铜 Copper	22-16A.W.G 0.5-1.5mm ²	红 Red	导线截面: 0.5-1.5mm ² (美国线规22~16) 最大电流: 19A 材质: 紫铜 镀层: 锡
BNY2	27.3	3.8	2.3	铜 Copper	16-14A.W.G 1.5-2.5mm ²	蓝 Blue	Cable size: 0.5-1.5mm ² (A.W.G22~16) Max current: I _{max} =27A
BNY5.5	27.3	5.3	3.4	铜 Copper	12-10A.W.G 4-6mm ²	黄 Yellow	Material: Copper Plating:Tin

FLAG FEMALE INSULATING JOINT (NYLON)

旗形母绝缘接头 (尼龙)

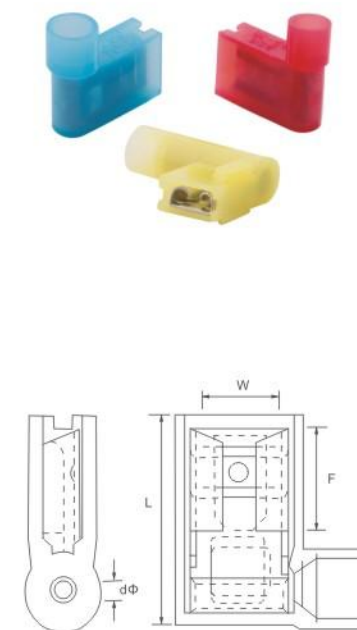

1_{max} = 22-18 A.W.G:10A 16-14 A.W.G:15A 12-10 A.W.G:24A

Max withstanding pressure:105°C600V Material:Brass Insulating
Cover Material:Nylon Thickness:0.4mm

型号 ITEM NO.	连接规格 Connect Specification	尺寸 Dimension(mm)				A.W.G (mm)	颜色 Color	说明 Explanation
		W	F	L	dΦ			
FLDNY 1.25-250	0.8x6.35	6.6	7.6	16.0	17	22-18A.W.G 0.5-1.5mm ²	红 Red	导线截面: 0.5-1.5mm ² (美国线规22~16)
FLDNY 2-250	0.8x6.35	6.6	7.6	16.0	17	16-14A.W.G 1.5-2.5mm ²	蓝 Blue	最大电流: 19A 材质: 紫铜 镀层: 锡 Cable size: 0.5-1.5mm ² (A.W.G22~16) Max current: I _{max} =27A
FLDNY 5.5-250	0.8x6.35	6.6	7.6	16.0	17	12-10A.W.G 4-6mm ²	黄 Yellow	Material: Copper Plating: Tin

MALE AND FEMALE FULL-INSULATING JOINT(NYLON)

公、母全绝缘接头(尼龙)



型号 ITEM NO.	连接规格 Connect Specification	尺寸 Dimension(mm)								A.W.G (mm)	颜色 Color
		W	F	L	B	DΦ	CΦ	T	Fig		
FDN 1.25-250	0.8x6.35	6.6	7.3	22.0	11.0	4.0	1.7	0.4	1	22-16 A.W.G 0.5-1.5 mm ²	红 Red
MDFN 1.25-250	0.8x6.35	6.35	7.7	23.0					2		
FDN 2-250	0.8x6.35	6.6	7.3	22.0	11.0	4.5	2.3	0.4	1	16-14 A.W.G 1.5-2.5 mm ²	蓝 Blue
MDFN 2-250	0.8x6.35	6.35	7.7	24.0					2		
FDN 5.5-250	0.8x6.35	6.6	7.3	24.0	13.0	6.3	3.4	0.4	1	12-10 A.W.G 4-6 mm ²	黄 Yellow
MDFN 5.5-250	0.8x6.35	6.35	7.7	25.0					2		

MALE AND FEMALE FULL-INSULATING JOINT(NYLON)

公、母全绝缘接头(尼龙)

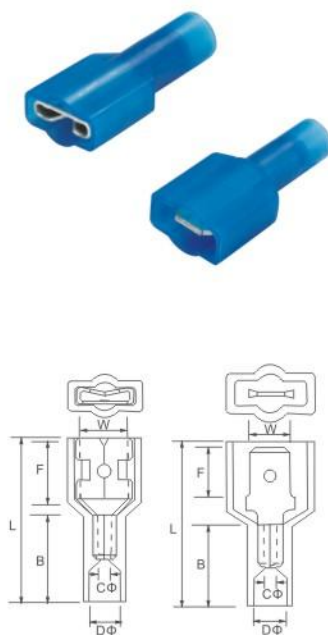

型号 ITEM NO.	连接规格 Connect Specification	尺寸 Dimension(mm)								A.W.G (mm)	颜色 Color
		W	F	L	B	DΦ	CΦ	T	Fig		
FDN 1.25-250	0.8x6.35	6.6	7.3	22.0	12.0	4.0	1.7	0.45	1	22-16 A.W.G 0.5-1.5 mm ²	红 Red
MDFN 1.25-250	0.8x6.35	6.35	7.7	23.0	11.0	4.0	1.7	0.8	2		
FDN 2-250	0.8x6.35	6.6	7.3	23.0	12.0	4.5	2.3	0.45	1	16-14 A.W.G 1.5-2.5 mm ²	蓝 Blue
MDFN 2-250	0.8x6.35	6.35	7.7	24.0	11.0	4.5	2.3	0.8	2		
FDN 5.5-250	0.8x6.35	6.6	7.3	23.0	12.0	5.0	3.4	0.45	1	12-10 A.W.G 4-6 mm ²	黄 Yellow
MDFN 5.5-250	0.8x6.35	6.35	7.7	24.0	11.0	5.0	3.4	0.8	2		

PVC INSULATED TERMINAL SLEEVE

绝缘软管套

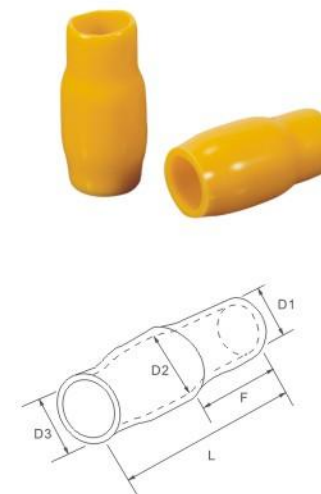

型号 ITEM NO.	尺寸 Dimension(mm)				
	D1	D2	D3	L	F
V1.25	2.8	3.3	3.1	13.0	7.0
V2	3.3	4.5	3.7	15.0	7.0
V3.5	4.2	5.7	4.1	20.0	8.0
V5.5	4.8	5.7	5.2	20.0	8.0
V8	6.2	7.2	6.2	20.0	9.0
V14	7.5	10.0	8.0	27.0	11.0
V22	10.5	12.0	9.5	30.0	15.0
V38	12.5	14.0	11.8	36.0	16.5
V60	15.0	16.8	13.5	39.0	19.0
V70	16.0	17.5	14.5	43.0	20.0
V80	17.0	19.0	16.0	47.0	22.0
V100	19.0	22.0	18.0	54.0	24.0
V125	21.0	24.0	20.0	57.0	25.0
V150	23.0	24.5	22.0	65.0	30.0
V200	27.0	32.0	24.0	65.0	30.0
V240	29.0	38.0	26.0	77.0	39.0
V325	29.0	38.0	29.0	77.0	40.0
V400	42.0	45.0	36.0	85.0	41.0
V500	46.0	48.0	40.0	88.0	42.0
V630	52.0	54.0	44.0	92.0	47.0

COPPER TUBE TERMINAL(DTGMK & DTGB) 窥口铜接线端子

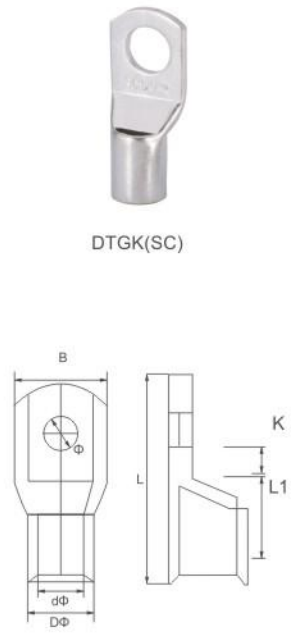

DTGK(SC)

型号 ITEM NO.	d2Φ (mm)	尺寸 Dimension(mm)				导体截面积 Conductor section (mm ²)	说明 Explanation
		dΦ	DΦ	L1	L		
DTGK							
SC 1.5-5	5.3	1.9	3.35	6.5	18.0	1.5	
SC 2.5-4	4.3	2.6	4.0	7.0	18.0	2.5	
SC 2.5-5	5.3	2.6	4.0	7.0	20.0	2.5	
SC 4-5	5.3	3.2	4.8	7.5	20.5	4	
SC 4-6	6.4	3.2	4.8	7.5	22.0	4	
SC 6-5	5.3	4.1	5.3	8.0	24.0	6	
SC 6-6	6.4	4.1	5.3	8.0	24.0	6	
SC 10-6	6.4	5.1	6.3	9.0	24.0	10	
SC 10-8	8.4	5.1	6.3	9.5	25.0	10	
SC 16-6	6.4	6.4	7.5	11.0	27.5	16	
SC 16-8	8.4	6.4	7.5	11.0	29.5	16	
SC 25-6	6.4	7.4	9.0	13.5	34.0	25	
SC 25-8	8.4	7.4	9.0	13.5	34.0	25	
SC 35-8	8.4	8.5	10.8	14.5	37.0	35	
SC 35-10	10.5	8.5	10.8	14.5	38.0	35	
SC 50-8	8.4	9.6	12.5	17.0	42.5	50	
SC 50-10	10.5	9.6	12.5	17.0	44.0	50	
SC 70-10	10.5	11.9	14.5	19.5	50.0	70	
SC 70-12	13.0	11.9	14.5	19.5	50.0	70	
SC 95-10	10.5	13.2	17.0	23.5	57.0	95	
SC 95-12	13.0	13.2	17.0	23.5	57.0	95	
SC 120-12	13.0	15.6	19.0	26.0	63.0	120	
SC 120-16	17.0	15.6	19.0	26.0	63.0	120	
SC 150-12	13.0	17.4	21.0	29.0	71.0	150	
SC 150-14	15.0	17.4	21.0	29.0	71.0	150	
SC 150-16	17.0	17.4	21.0	29.0	71.0	150	
SC 185-12	13.0	19	23.0	32.0	72.0	185	
SC 185-14	15	19	23.0	32.0	72.0	185	
SC 185-16	17.0	19	23.0	32.0	72.0	185	
SC 240-12	13.0	21.8	26.0	38.0	92.0	240	
SC 240-14	15.0	21.8	26.0	38.0	92.0	240	
SC 240-16	17.0	21.8	26.0	38.0	92.0	240	
SC 240-20	21.0	21.8	26.0	38.0	92.0	240	
SC 300-12	13.0	24.8	30.0	43.0	101.0	300	
SC 300-16	17.0	24.8	30.0	43.0	101.0	300	
SC 300-20	21.0	24.8	30.0	43.0	101.0	300	
SC 400-16	17.0	28.0	34.0	46.0	110.0	400	
SC 400-20	21.0	28.0	34.0	46.0	110.0	400	
SC 500-16	17.0	30.0	38.0	47.0	119.0	500	
SC 500-20	21.0	30.0	38.0	47.0	119.0	500	
SC 630-20	21.0	35.0	45.0	56.0	135.0	630	

DTGK,窥口铜接线端子
DTGY,铜接线端子
DTGB喇叭口型铜接线端子

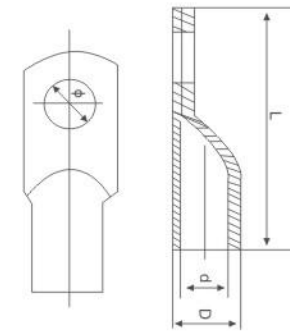

JG

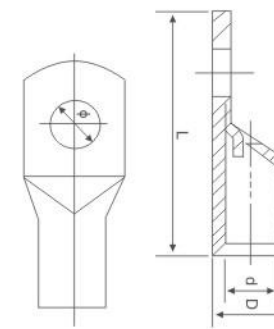

SC(JGY)

APPLICATION 用途

JG 适用于配电装置中电线、电力电缆与电气设备的连接。采用(T2)铜管料压制,表面镀锡。
适用于标称截面1.5-1000mm²电力电缆式电线的铜导体与电气设备的连接,特点,采用管料含铜量>99.9%的高纯T2铜管制造,长期工作温度-55℃-150℃,表面镀锡。

These products are applicable to the connection of wires in distribution equipment power supply cable with electronic apparatus, it is made of (T2) copper tube by die cast and coated tin.

These products are suitable for the connection of copper conductors (section 1.5-1000mm²) in power cable with electronic equipment they are made of with higher 99.9percent pure copper tube T2 and coated with tin. working temperature-55℃-150℃.

型号 ITEM NO.	φ	D	d	L
JG-10	6.2	8	5	38
JG-16	8.4	9	6	41
JG-25	8.4	10	7	46
JG-35	8.5	11	8	52
JG-50	8.5	13	10	54
JG-70	10.5	16	12	61
JG-95	10.5	18	14	66
JG-120	12.5	20	15	73
JG-150	12.5	23	17	77
JG-185	14.5	25	19	86
JG-240	16.5	27	21	93
JG-300	16.5	31	24	103
JG-400	18.5	34	26	113
JG-500	20.5	38	30	124
JG-630	22.5	45	35	140
JG-800	22.5	50	40	170

型号 ITEM NO.	φ	D	d	L
SC(JGY)-6	φ 5.2, φ 6.2, φ 8.2	5.5	4.1	27.6
SC(JGY)-10	φ 6.2, φ 8.2	6.5	5.1	33.5
SC(JGY)-16	φ 6.2, φ 8.2, φ 10.5	8	6.4	35.5
SC(JGY)-25	φ 6.2, φ 8.2, φ 10.5	9	7.4	38.4
SC(JGY)-35	φ 6.2, φ 8.2, φ 10.5, φ 12.5	10.5	8.5	48.4
SC(JGY)-50	φ 8.2, φ 10.5, φ 12.5	12	9.6	52
SC(JGY)-70	φ 8.2, φ 10.5, φ 12.5	14.5	11.9	58.2
SC(JGY)-95	φ 10.5, φ 12.5	16	13.2	69
SC(JGY)-120	φ 12.5, φ 16.5	19	15.6	71.2
SC(JGY)-150	φ 12.5, φ 16.5	21	17.4	81.7
SC(JGY)-185	φ 16.5	23	19	82
SC(JGY)-240	φ 16.5	26	21.8	91
SC(JGY)-300	φ 16.5, φ 20.5	30	24.8	100

APPLICATION 用途

适用于标称截面1.5-1000mm²电力电缆式电线的铜导体与电气设备的连接，特点，采用管料含铜量>99.9%的高纯T2铜管制造，长期工作温度-55℃-150℃，表面镀锡。

连接管适用于配电装置中各种圆型，半圆扇型电线，电力电缆之间的连接。GTL系列堵油型连接管。采用摩擦焊工艺制造，质量可靠。

These products are suitable for the connection of copper conductors (section 1.5-1000mm²) in power cable with electronic equipment they are made of with higher 99.9percent pure copper tube T2 and coated with tin. working temperature-55℃-150℃.

These products are applicable connect the circular wire and hemicycle-sector wire in distribution equipment or power supply cables, GTL series connecting tube is made of friction-welding craft, both top quality.

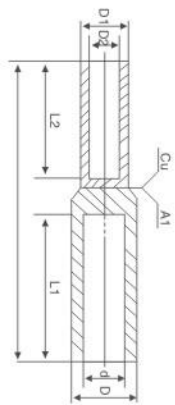
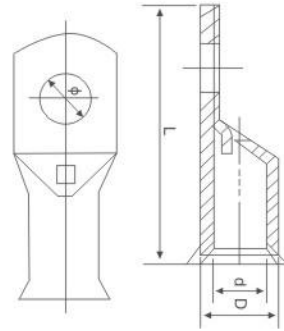

GTL

型号 ITEM NO.	φ	D	d	L
SC(JGB)-6	φ 5.2, φ 6.2, φ 8.2	5.5	4.1	27.6
SC(JGB)-10	φ 6.2, φ 8.2	6.5	5.1	33.5
SC(JGB)-16	φ 6.2, φ 8.2, φ 10.5	8	6.4	35.5
SC(JGB)-25	φ 6.2, φ 8.2, φ 10.5	9	7.4	38.4
SC(JGB)-35	φ 6.2, φ 8.2, φ 10.5, φ 12.5	10.5	8.5	48.4
SC(JGB)-50	φ 8.2, φ 10.5, φ 12.5	12	9.6	52
SC(JGB)-70	φ 8.2, φ 10.5, φ 12.5	14.5	11.9	58.2
SC(JGB)-95	φ 10.5, φ 12.5	16	13.2	69
SC(JGB)-120	φ 12.5, φ 16.5	19	15.6	71.2
SC(JGB)-150	φ 12.5, φ 16.5	21	17.4	81.7
SC(JGB)-185	φ 16.5	23	19	82
SC(JGB)-240	φ 16.5	26	21.8	91
SC(JGB)-300	φ 16.5, φ 20.5	30	24.8	100

型号 ITEM NO.	D	d	D1	L1	L2	L
GTL-16	10	6	9	30	30	70
GTL-25	12	7	10	33	30	75
GTL-35	14	8.5	11	40	30	85
GTL-50	16	9.8	13	42	32	95
GTL-70	18	11.5	15	50	38	105
GTL-95	21	13.5	17	50	40	110
GTL-120	23	15	19	55	42	112
GTL-150	25	17	21	55	44	118
GTL-185	27	18.5	23	60	46	125
GTL-240	30	21	26	60	54	130
GTL-300	34	23	28	65	56	145
GTL-400	38	27	30	70	60	155
GTL-500	43	29	34	75	65	165

APPLICATION 用途

DTL 系列铜铝接线端子适用于配电装置中各种圆型、半圆扇型铝线、电力电缆与电气设备铜端的过渡连接。使用铝材为L3，铜材为T2。产品采用摩擦焊工艺制造，具有焊缝强度高，通电性能好，抗电化腐蚀，使用寿命长等特点。

DTL series of copper-aluminum wiring terminals are suitable for transition connection of the circular aluminium wires, hemicycle-sector aluminium wires, power supply cables in the distribution equipment and copper terminals of the electrical equipment. The material of aluminum and copper is that of L3 and T2 respectively. The technology of friction weld - ing is wonderfully adopted. Therefore they have disinguishing features of strong weld intensity, good nature in electrification, resistant galvanic corrosion and long service life.

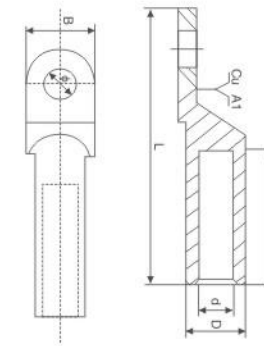

DTL-1

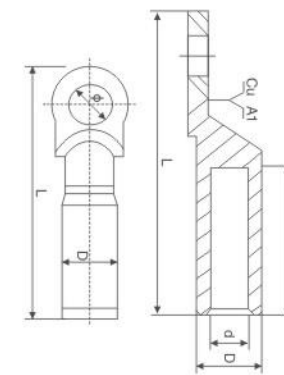

DTL-2

型号 ITEM NO.	φ	D	d	L	L1	B
DTL-1-10	8.5	10	6	68	28	16
DTL-1-16	8.5	11	6	70	30	16
DTL-1-25	8.5	12	7	75	34	18
DTL-1-35	10.5	14	8.5	85	38	20.5
DTL-1-50	10.5	16	9.8	90	40	23
DTL-1-70	12.5	18	11.5	102	48	26
DTL-1-95	12.5	21	13.5	112	50	28
DTL-1-120	14.5	23	15	120	53	30
DTL-1-150	14.5	25	16.5	126	56	34
DTL-1-185	16.5	27	18.5	133	58	37
DTL-1-240	16.5	30	21	140	60	40
DTL-1-300	21	34	23.5	160	65	50
DTL-1-400	21	38	27	170	70	50
DTL-1-500	21	47	29	225	75	60
DTL-1-630	-	54	35	245	80	80
DTL-1-800	-	60	38	270	90	100

型号 ITEM NO.	φ	D	d	L	L1
DTL-2-16	13	16	5.5	87	42
DTL-2-25	13	16	6.5	87	42
DTL-2-35	13	16	8	87	42
DTL-2-50	13	20	9	87	43
DTL-2-70	13	20	11	87	43
DTL-2-95	13	20	12.5	87	43
DTL-2-120	13	25	13.5	111	60
DTL-2-150	13	25	15.5	111	60
DTL-2-185	13	32	17.5	116	60
DTL-2-240	13	32	19.5	116	60
DTL-2-300	13	34	22.5	120	62

OPEN BARREL TERMINALS (FEMALE & MALE)



型号 ITEM NO.	材料 Metal	线径范围 Wire range	尺寸 Dimension(mm)			厚度 Thickness
			D	W	E	
Y 3-2.5	铜 Brass	0.5-2.5	3.2			0.6
DJ 431-3A		0.5-0.8	3.5	9.0	17.0	0.5
DJ 431-5A		0.5-0.8	5.2	10.0	17.0	0.5
DJ 431-6A		0.5-0.8	6.2	12.0	17.0	0.5
DJ 431-8B		1.0-1.5	8.2	15.0	17.0	0.8
DJ 431-10B		1.0-1.5	10.5	19.0	19.0	0.8

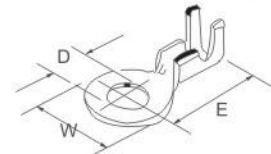

序号 Fig	型号 ITEM NO.	材料 Metal	线径范围 Wire range	尺寸 Dimension(mm)				厚度 Thickness
				D	W	L	E	
A	DJ611-2.8x0.5B	铜 Brass	1.0-1.5		2.8	21.0	12.0	0.5
B	DJ611-6.3A		0.5-0.8	7.9	6.3	25.0	13.8	0.4
B	DJ611-6.3B		1.0-1.5	7.9	6.3	25.0	13.8	0.4
B	DJ612-6.3C		2.0-2.5	7.9	6.3	25.0	13.8	0.4
C	DJ617-6.3B		1.0-1.5		6.3	19.2		0.4

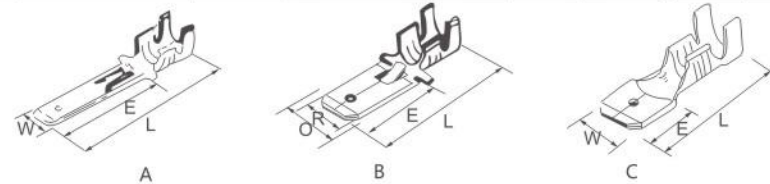

序号 Fig	型号 ITEM NO.	材料 Metal	线径范围 Wire range	尺寸 Dimension(mm)			厚度 Thickness
				W	L	E	
A	DJ621-E2.8x0.5B	铜 Brass	1.0-1.5	4.1	16.0	6.6	0.3
A	DJ621-D2.8x0.5A		0.5-0.8	3.7	15.1	6.3	0.25
A	DJ621-E2.8x0.5A		0.5-0.8	6.0	13.8		0.3
B	DJ625-4.8x0.8A		0.5-0.8	6.4	12.0	6.2	0.4
C	DJ621-5A		0.5-0.8	5.2	17	5.5	0.3
C	DJ611-5B		1.0-1.5	5.2	17	5.5	0.3
D	DJ622-A6.3B		1.0-1.5	7.7	18.5	7.5	0.3
E	DJ622-D6.3A		1.0-1.5	7.7	17.5	7.5	0.4

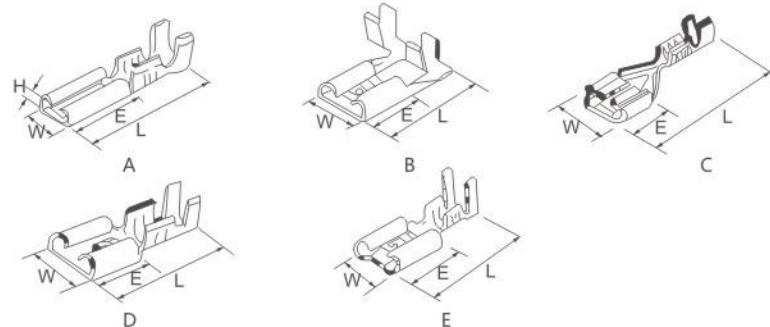

OPEN BARREL TERMINALS (FEMALE & MALE)



序号 Fig	型号 ITEM NO.	材料 Metal	线径范围 Wire range	尺寸 Dimension(mm)					厚度 Thickness
				D	H	W	L	E	
A	DJ211-3.5B	铜 Brass	1.0-1.5			3.5	15.0		0.5
A	DJ211-4B		1.0-1.5			4.0	16.0		0.5
B	DJ221-2.3B		1.0-1.5			3.9	19.0	17.4	0.3
B	DJ221-3.5B		1.0-1.5			3.3	17.6	6.5	0.3
B	DJ221-4B		1.0-1.5			3.8	17.6	6.5	0.4

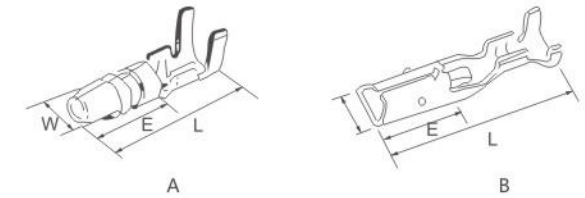

TERMINALS BLOCKS

TERMINAL BLOCKS H,Y(W),V(F)TYPE Material:made from PA,PE or PP.

Application

H.FW.Series terminal connectors are used in the circuits of AC.50Hz or 60Hz voltage up to 660V or DC.Voltage up to 440V current from 3A to 150A, for connecting the round copper conductors.

Specification

型号 ITEM NO.	L	A	H	M	B	mm ²	VOLT	AMP	包装 Packing
DL-3A	93	16	16	6	8	4	400V	3A	10PCS
DL-6A	115	15.7	15.7	6.5	9.5	6	400V	6A	
DL-10A	126	20.2	20.2	8.4	10.5	10	400V	10A	
DL-16A	139	23	23	10.3	12	12	400V	16A	
DL-20A	155	25	25	11.5	13.5	14	400V	20A	
DL-30A	171	26	26	12	14.5	16	400V	30A	
DL-60A	192	30	30	13.5	16.5	25	400V	60A	
DL-80A	205	33	33	15	17	35	400V	80A	
DL-100A	250	46	46	22	21	40	400V	100A	

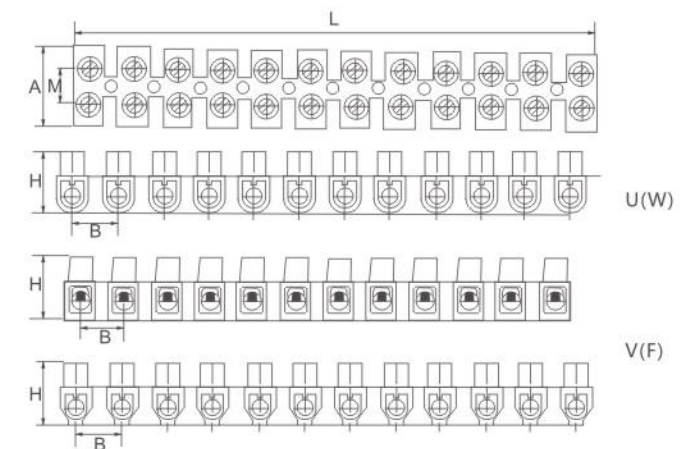

CIRCLE CABLE CLIPS

Material: PP, Steel nail.

How to use: Put the cable under the clip and hammer the nail into the wall to secure the cable.

Application: Securinnl of Galbes for general indoor wiring



型号 ITEM NO.	H (mm)	R (mm)	Nail (mm)	包装 Packing
4mm	5.3	4	1.7x15	100PCS
5mm	6.5	5	1.7x15	
6mm	8.1	6	1.7x15	
7mm	8.7	7	1.8x19	
8mm	9.6	8	1.9x21	
9mm	10.7	9	2.0x22	
10mm	11.7	10	2.05x25	
12mm	12.8	12	2.05x27	
14mm	14.9	14	2.4x32	
16mm	16.9	16	2.5x35	
18mm	20.8	18	2.8x37	
20mm	23.6	20	2.8x42	
22mm	25.0	22	2.8x48	
25mm	27.7	25	3.2x48	
30mm	33.1	30	3.2x53	
35mm	36.6	35	3.2x58	
40mm	45.2	40	3.4x60	

SQUARE CABLE CLIPS

Material: PP, Steel nail.

How to use: Put the cable under the clip and hammer the nail into the wall to secure the cable.

Application: Securinnl of Galbes for general indoor wiring

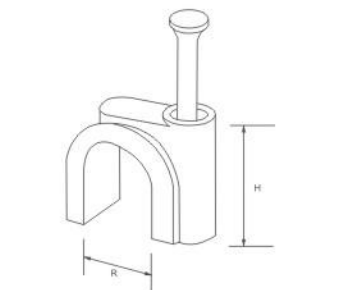
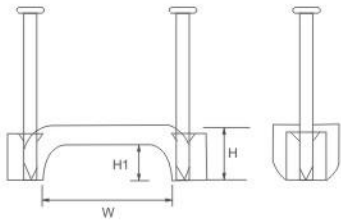
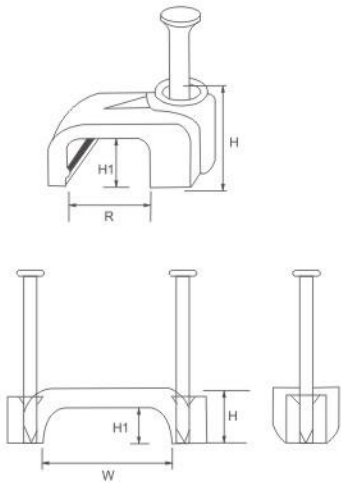

型号 ITEM NO.	H (mm)	IN-DIAMETER		Nail MM	包装 Packing
		H1 (mm)	R (mm)		
4mm	6.0	3.8	4	1.7x15	100PCS
5mm	6.0	3.8	5	1.7x15	
6mm	6.5	4.1	6	1.7x16	
7mm	7.0	4.7	7	1.9x18	
8mm	7.5	5.0	8	2.05x20	
9mm	8.2	5.4	9	2.05x23	
10mm	8.6	5.7	10	2.3x23	
12mm	9.0	6.1	12	2.3x23	
14mm	11.2	6.5	14	2.4x30	

DOUBLE NAIL FLAT CABLE CLIPS

型号 ITEM NO.	W	H	H1	SUITABLE WIRES	NAILS	包装 Packing
DL-13	12.5	8	8	#14/2 14/3 12/2	1.86X31	100PCS
DL-19	18.7	8	8	#12/3 10/23 10/3	1.86X31	



型号 Model	PCT-102(黄色/透明)	PCT-104(橙色/透明)	PCT-106(紫色/透明)
外形尺寸 Outline size			
额定电压 Rated voltage	V	400	400
额定电流 Rated current	A	24	24
导线线径 Wire diameter	mm ²	0.75-2.5	0.75-2.5
耐电压 Voltage resistance	kV	2.5	2.5
机械性能 Mechanical properties			
电位数量 Potential quantity	°C	1	1
剥线长度 Strip length	mm	12	12
长×宽×高 L/W/H		19.5×9.4×13.1	19.5×13×13.1
极数 The number of poles	P	2	4
材质和电镀 Material and plating			
塑件 Plastic parts	PC,UL94,V-2	PC,UL94,V-2	PC,UL94,V-2
弹片 Shrapnel	不锈钢 Stainless steel	不锈钢 Stainless steel	不锈钢 Stainless steel
触电材料 Contact material	电解铜镀镍 Electrolytic copper nickel tin	电解铜镀镍 Electrolytic copper nickel tin	电解铜镀镍 Electrolytic copper nickel tin



型号 Model	PCT-108	PCT-103D(红色/透明)	PCT-104D
外形尺寸 Outline size			
额定电压 Rated voltage	V	400	600
额定电流 Rated current	A	24	35
导线线径 Wire diameter	mm ²	0.75-2.5	0.75-2.5
耐电压 Voltage resistance	kV	2.5	2.5
机械性能 Mechanical properties			
电位数量 Potential quantity	°C	1	1
剥线长度 Strip length	mm	12	13
长×宽×高 L/W/H		19.5×24×13.1	25.6×20.1×14.2
极数 The number of poles	P	8	3
材质和电镀 Material and plating			
塑件 Plastic parts	PC,UL94,V-2	PC,UL94,V-2	PC,UL94,V-2
弹片 Shrapnel	不锈钢 Stainless steel	不锈钢 Stainless steel	不锈钢 Stainless steel
触电材料 Contact material	电解铜镀镍 Electrolytic copper nickel tin	电解铜镀镍 Electrolytic copper nickel tin	电解铜镀镍 Electrolytic copper nickel tin



型号 Model	PCT-212(2孔)	PCT-213(3孔)	PCT-214(4孔)
外形尺寸 Outline size			
参考标准 Reference standard	IEC	IEC	IEC
额定电压 Rated voltage	V 450	450	450
额定电流 Rated current	A 32	32	32
导线线径 Wire diameter	AWG/mm ² 0.14(0.2)-4mm ²	0.14(0.2)-4mm ²	0.14(0.2)-4mm ²
耐电压 Voltage resistance	kV 2.5	2.5	2.5
机械性能 Mechanical properties			
电位数量 Potential quantity	°C -40°C~+105°C	-40°C~+105°C	-40°C~+105°C
剥线长度 Strip length	mm 11	11	11
长×宽×高 L/W/H	20.5×12.4×14.5	20.5×17×14.5	20.5×26.6×14.5
极数 The number of poles	p 2	3	5
材质和电镀 Material and plating			
塑件 Plastic parts	PA66	PA66	PA66
弹片 Shrapnel	不锈钢 Stainless steel	不锈钢 Stainless steel	不锈钢 Stainless steel
触电材料 Contact material	电解铜镀镍 Electrolytic copper nickel tin	电解铜镀镍 Electrolytic copper nickel tin	电解铜镀镍 Electrolytic copper nickel tin



型号 Model	PCT-215(5孔)	PCT-218(8孔)	PCT-214(4孔)
外形尺寸 Outline size			
参考标准 Reference standard	IEC	IEC	IEC
额定电压 Rated voltage	V 450	450	450
额定电流 Rated current	A 32	32	32
导线线径 Wire diameter	AWG/mm ² 0.14(0.2)-4mm ²	0.14(0.2)-4mm ²	0.14(0.2)-4mm ²
耐电压 Voltage resistance	kV 2.5	2.5	2.5
机械性能 Mechanical properties			
电位数量 Potential quantity	°C -40°C~+105°C	-40°C~+105°C	-40°C~+105°C
剥线长度 Strip length	mm 11	11	11
长×宽×高 L/W/H	20.5×26.6×14.5	40.5×20.5×14.5	38×13×14
极数 The number of poles	p 5	8	4
材质和电镀 Material and plating			
塑件 Plastic parts	PA66	PA66	PA66
弹片 Shrapnel	不锈钢 Stainless steel	不锈钢 Stainless steel	不锈钢 Stainless steel
触电材料 Contact material	电解铜镀镍 Electrolytic copper nickel tin	电解铜镀镍 Electrolytic copper nickel tin	电解铜镀镍 Electrolytic copper nickel tin



型号 Model	PCT-3(6孔)		
外形尺寸 Outline size			
参考标准 Reference standard	IEC	IEC	
额定电压 Rated voltage	V 450	450	
额定电流 Rated current	A 32	32	
导线线径 Wire diameter	AWG/mm ² 0.14(0.2)-4mm ²	0.14(0.2)-4mm ²	
耐电压 Voltage resistance	kV 2.5	2.5	
机械性能 Mechanical properties			
电位数量 Potential quantity	°C -40°C~+105°C	-40°C~+105°C	
剥线长度 Strip length	mm 11	11	
长×宽×高 L/W/H	38×18×14	42.6×8×30.5	
极数 The number of poles	p 6	2	
材质和电镀 Material and plating			
塑件 Plastic parts	PA66	PA66	
弹片 Shrapnel	不锈钢 Stainless steel	不锈钢 Stainless steel	
触电材料 Contact material	电解铜镀镍 Electrolytic copper nickel tin	电解铜镀镍 Electrolytic copper nickel tin	



型号 Model	PCT-252	PCT-253	PCT-254	PCT-255
外形尺寸 Outline size				
参考标准 Reference standard	IEC	IEC	IEC	IEC
额定电压 Rated voltage	V 450	450	450	450
额定电流 Rated current	A 32	32	32	32
导线线径 Wire diameter	AWG/mm ² 0.5-4mm ²	0.5-4mm ²	0.5-4mm ²	0.5-4mm ²
耐电压 Voltage resistance	kV 2.5	2.5	2.5	2.5
机械性能 Mechanical properties				
电位数量 Potential quantity	°C -40°C~+105°C	-40°C~+105°C	-40°C~+105°C	-40°C~+105°C
剥线长度 Strip length	mm 11	11	11	11
长×宽×高 L/W/H	20×10.5×9.8	20×14.3×9.8	20×17.8×9.8	20×21.2×9.8
极数 The number of poles	p 2	3	4	5
材质和电镀 Material and plating				
塑件 Plastic parts	PC,UL94,V-2	PC,UL94,V-2	PC,UL94,V-2	PC,UL94,V-2
弹片 Shrapnel	不锈钢 Stainless steel	不锈钢 Stainless steel	不锈钢 Stainless steel	不锈钢 Stainless steel
触电材料 Contact material	电解铜镀镍 Electrolytic copper nickel tin	电解铜镀镍 Electrolytic copper nickel tin	电解铜镀镍 Electrolytic copper nickel tin	电解铜镀镍 Electrolytic copper nickel tin



型号 Model	PCT-412	PCT-413	PCT-414	PCT-415
外形尺寸 Outline size				
参考标准 Reference standard	IEC	IEC	IEC	IEC
额定电压 Rated voltage	V	450	450	450
额定电流 Rated current	A	32	32	32
导线线径 Wire diameter	AWG/mm ²	0.14(0.2)-4mm ²	0.14(0.2)-4mm ²	0.14(0.2)-4mm ²
耐电压 Voltage resistance	kV	2.5	2.5	2.5
机械性能 Mechanical properties				
电位数量 Potential quantity	°C	-40°C~+105°C	-40°C~+105°C	-40°C~+105°C
剥线长度 Strip length	mm	11	11	11
长×宽×高 L/W/H		18.6×13×11	18.6×19.1×11	18.6×29.9×11
极数 The number of poles	P	2	3	5
材质和电镀 Material and plating				
塑件 Plastic parts	PC,UL94,V-2	PC,UL94,V-2	PC,UL94,V-2	PC,UL94,V-2
弹片 Shrapnel	不锈钢 Stainless steel	不锈钢 Stainless steel	不锈钢 Stainless steel	不锈钢 Stainless steel
触电材料 Contact material	电解铜镀镍 Electrolytic copper nickel tin	电解铜镀镍 Electrolytic copper nickel tin	电解铜镀镍 Electrolytic copper nickel tin	电解铜镀镍 Electrolytic copper nickel tin



型号 Model	EU2.5-412(2孔)	EU2.5-413(3孔)	EU2.5-414(4孔)	EU2.5-415(5孔)
外形尺寸 Outline size				
参考标准 Reference standard	IEC	IEC	IEC	IEC
额定电压 Rated voltage	V	450	450	450
额定电流 Rated current	A	32	32	32
导线线径 Wire diameter	AWG/mm ²	0.5-4mm ²	0.5-4mm ²	0.5-4mm ²
耐电压 Voltage resistance	kV	2.5	2.5	2.5
机械性能 Mechanical properties				
电位数量 Potential quantity	°C	-40°C~+105°C	-40°C~+105°C	-40°C~+105°C
剥线长度 Strip length	mm	11	11	11
长×宽×高 L/W/H		16.7×10×5.8	16.7×14×5.8	16.7×22×5.8
极数 The number of poles	P	2	3	5
材质和电镀 Material and plating				
塑件 Plastic parts	PC,UL94,V-2	PC,UL94,V-2	PC,UL94,V-2	PC,UL94,V-2
弹片 Shrapnel	不锈钢 Stainless steel	不锈钢 Stainless steel	不锈钢 Stainless steel	不锈钢 Stainless steel
触电材料 Contact material	电解铜镀镍 Electrolytic copper nickel tin	电解铜镀镍 Electrolytic copper nickel tin	电解铜镀镍 Electrolytic copper nickel tin	电解铜镀镍 Electrolytic copper nickel tin



型号 Model	EU2.5-422	EU2.5-424	EU2.5-426(6孔)	EU2.5-428(8孔)
外形尺寸 Outline size				
参考标准 Reference standard	IEC	IEC	IEC	IEC
额定电压 Rated voltage	V	450	450	450
额定电流 Rated current	A	32	32	32
导线线径 Wire diameter	AWG/mm ²	0.5-2.5mm ²	0.5-2.5mm ²	0.5-2.5mm ²
耐电压 Voltage resistance	kV	2.5	2.5	2.5
机械性能 Mechanical properties				
电位数量 Potential quantity	°C	-40°C~+105°C	-40°C~+105°C	-40°C~+105°C
剥线长度 Strip length	mm	11	11	11
长×宽×高 L/W/H		16×11×5.5	16×10×11	16.7×14×5.8
极数 The number of poles	P	2	4	8
材质和电镀 Material and plating				
塑件 Plastic parts	PC,UL94,V-2	PC,UL94,V-2	PC,UL94,V-2	PC,UL94,V-2
弹片 Shrapnel	不锈钢 Stainless steel	不锈钢 Stainless steel	不锈钢 Stainless steel	不锈钢 Stainless steel
触电材料 Contact material	电解铜镀镍 Electrolytic copper nickel tin	电解铜镀镍 Electrolytic copper nickel tin	电解铜镀镍 Electrolytic copper nickel tin	电解铜镀镍 Electrolytic copper nickel tin



型号 Model	PCT-111(深灰色)	CH-2按压式接线端子	CH-3按压式接线端子
外形尺寸 Outline size			
额定电压 Rated voltage	V		
额定电流 Rated current	A	24	20
导线线径 Wire diameter	mm ²		
耐电压 Voltage resistance	kV	2.5	
机械性能 Mechanical properties			
电位数量 Potential quantity	°C	1	
剥线长度 Strip length	mm		
长×宽×高 L/W/H		20.5×8.5×15.5	
极数 The number of poles	P		
材质和电镀 Material and plating			
塑件 Plastic parts			
弹片 Shrapnel	不锈钢 Stainless steel	不锈钢 Stainless steel	不锈钢 Stainless steel
触电材料 Contact material			

